



2026 Partner Sales Prospectus

**2026 SIOP Annual
Conference**
April 29-May 2, 2026

New Orleans Ernest N. Morial
Convention Center



**SIOP ANNUAL
CONFERENCE**

NEW ORLEANS • April 29-May 2, 2026

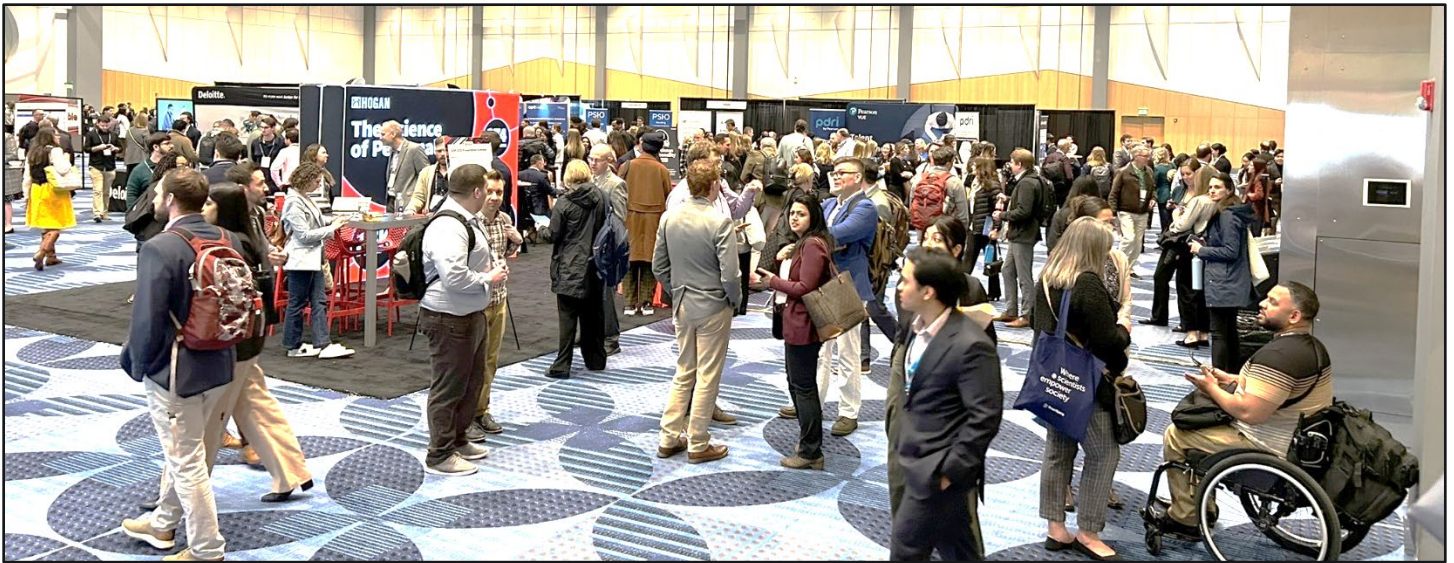

Table of Contents

Convention Center & Conference Hotel	2
Partner-Level Benefits	3-4
Who Attends the SIOP Annual Conference?	5-7
Advertising	8
Photos from 2025	9-10
Exhibiting-Exhibit Hall Floorplan	11-12
Booth Sizes & Pricing, Plus How to Purchase	13
Exhibitor Services (AV, Carpet, Catering, Electrical, Furniture, Lead Retrieval, Shipping, Wi-Fi)	14-16
Exhibit Hall Schedule	17
“Exhibit Hall-Only” vs “Attendee” Registrations	18
Photos from 2025	19-20
Sponsorships (List)	21-24
Appendix A: 2025 Sending Companies	25-32

Time to Prepare for #SIOP26!

April 29-May 2, 2026

Ernest N. Morial Convention Center
900 Convention Center Blvd
New Orleans, LA 70130
<https://mccno.com>

The Exhibit Hall will be in Hall B1-2.

Sales Contact:
Susan K. Rogers, CAE
Business Development Manager
srogers@siop.org



Conference Hotel

Hilton New Orleans Riverside
2 Poydras Street
New Orleans, LA 70130

Always book your room through the official accommodations link on the SIOP conference website to receive the conference rates: www.siop.org/events/the-annual-conference/attendee-info/hotel-reservations

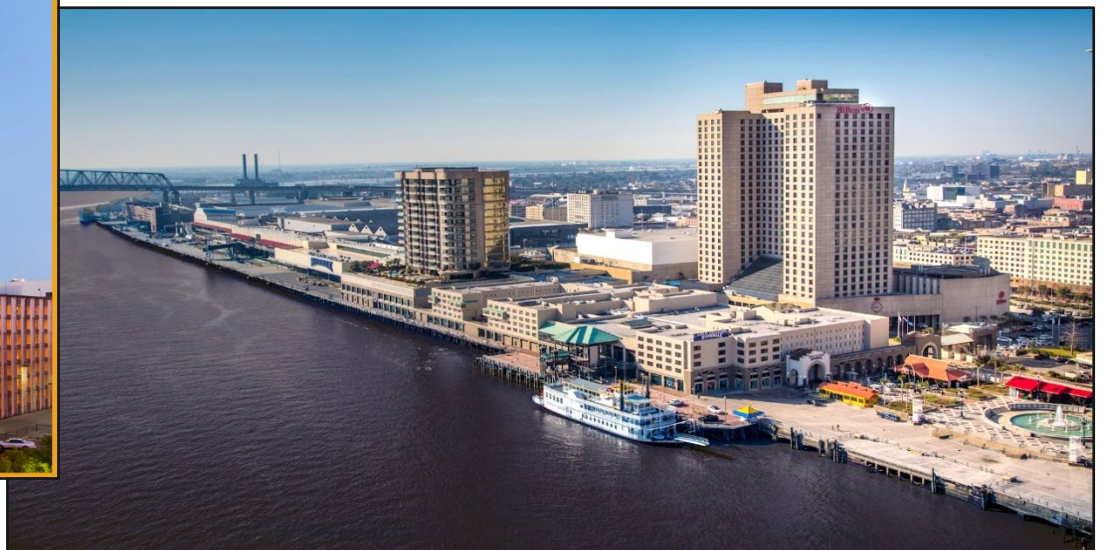

Partner-Level Benefits

- Partner-Level Benefits are awarded based on your final total, cumulative spend.
- The final invoice must equal the minimum amount of the partner level.
- Only one organization is assigned to a partner level. Partner levels cannot be shared among two or more organizations.

Levels	Platinum	Gold	Silver	Bronze
Fees	\$25,000+	\$15,000 to \$24,999	\$5,000 to \$14,999	\$1 to \$4,999
Prior to the Annual Conference				
Complimentary full-conference registration (\$799 Value Per Reg)	3 Comp Registrations	2 Comp Registrations	1 Comp Registrations	0 Comp Registrations
Ability to purchase additional full-conference registrations as a discount.	3 Registrations at a 30% Discount	2 Registrations at a 25% Discount	1 Registration at a 15% Discount	No Discounts
Pre-Registrant Mailing List (U.S. Only) • One (1) list per partner. • Emailed to partner representative on March 11, 2026. • No emails/phone numbers are included. • Registrants must be opted in to be on this list	YES	YES	YES	YES
One virtual booth space on virtual platform	YES	YES	YES	YES
One (1) complimentary ad in weekly member newsletter, SIOF Source	Ad Space A	Ad Space B	No Ad	No Ad
Recognition on a high-traffic SIOF Annual Conference web page	Logo	Logo	Name	No Listing
Recognition in annual conference promotional emails	Logo	Logo	Name	No Listing
Recognition on social media	Logo	Logo	Name	No Post

During the Annual Conference				
Recognition on conference-branded signage in the registration area	Logo	Logo	Name	Name
Inclusion in pre-show scrolling slides at plenary session	Individual Slide	Group Slide	No	No

Recognition in Sponsor Profile area of conference platform	Logo	Logo	Name	No
--	------	------	------	----

After the Annual Conference				
Attendees Mailing List (U.S. Only) <ul style="list-style-type: none"> • One (1) list per partner. • Emailed to partner representative on May 11, 2026. • No emails/phone numbers are included. • Registrants must be opted in to be on this list. 	YES	YES	YES	YES
Sponsor email blast to all attendees post-event. Email must be sent prior to June 30, 2026.	YES	No	No	No

Questions? Contact Susan K. Rogers, CAE, SIOP Business Development Manager, srogers@siop.org

Who Attends the SIOP Annual Conference?

Since 2015, the average attendance at a SIOP in-person annual conference is 4,391, which includes post-pandemic events.

Year	Attendance	Location
2025	4,376	Denver
2024	5,100	Chicago & Virtual
2023	5,066	Boston & Virtual
2022	4,132	Seattle & Virtual
2021	3,154	Virtual
2020	2,142	Virtual
2019	5,348	Natl Harbor
2018	5,525	Chicago
2017	4,801	Orlando
2016	4,338	Anaheim
2015	4,322	Philadelphia

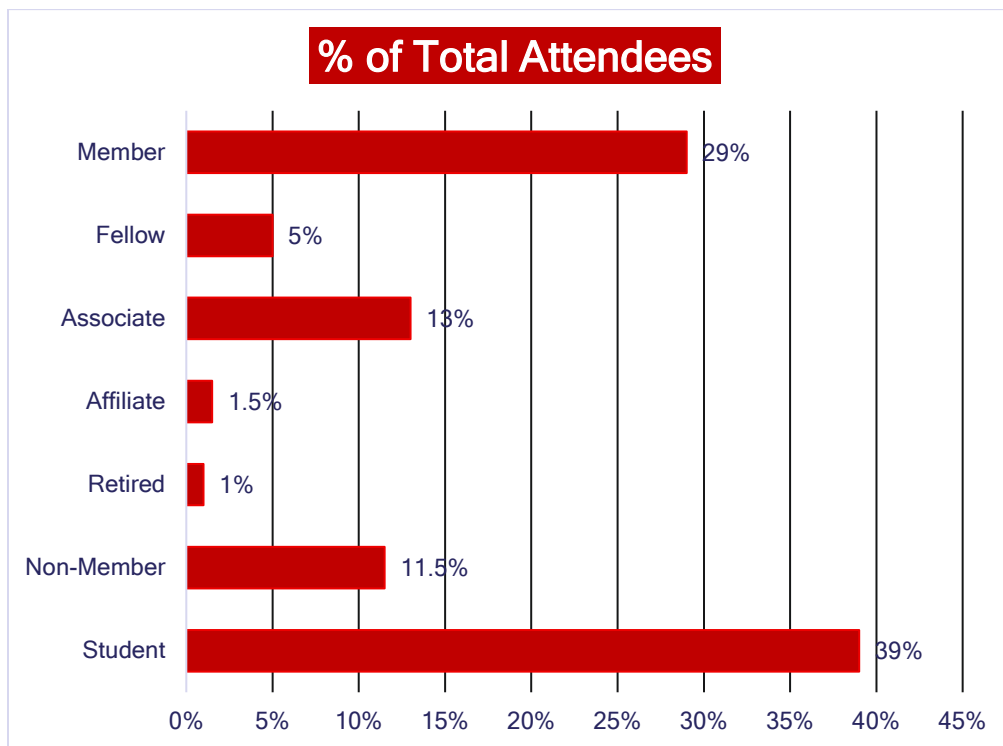

Don't count them out! 20-25% of student members work full-time while they pursue a graduate-level degree. Even full-time graduate students need to know about your products and services. They could be future customers.

Attendee Areas of Interest:

Attendees are interested in learning about products and services in these areas.

Assessments & Testing

- Career Development, Mentoring & Onboarding
- Coaching
- Counterproductive Behavior
- Culture
- Diversity, Inclusion & Belonging
- Employee Engagement & Retention
- Ethics
- Innovation & Creativity
- Global, International & Cross-Cultural Issues
- Legal Issues & Employment Law
- Leadership Development
- Measurement & Statistical Techniques
- Motivation, Rewards & Compensation
- Performance Appraisal & Feedback
- Research Methodology
- Teams Development
- Work & Family, Non-Work Life and Leisure

Typical Attendee Job Titles:

The hierarchical levels within a worker's career stage typically are:

- Individual Contributor: an entry level employee who does not directly supervise others
- Expert Individual Contributor: a non-management track worker who is considered an expert in one's field of work but does supervise other individuals
- Manager: a first-line manager who is responsible for the supervision of other professionals or individual contributors
- Manager of Other Managers: second- and third-line managers who oversee multiple managers or departments
- Executive: a leader of the organization

Job Titles in Academia

- Individual Contributor: Assistant Professor, Associate Professor
- Expert Individual Contributor: Full Professor
- Manager: Department Chair
- Manager of Managers: Dean
- Executive: Vice President, Provost, President

Job Titles in Government

- Individual Contributor: Analyst, Associate, Consultant
- Expert Individual Contributor: Expert
- Manager: Case Team Leader, Manager, Senior Associate Consultant, Project Leader
- Manager of Managers: Senior Manager
- Executive: Executive, Senior Executive, Partner, Director

Job Titles in Industry

- Individual Contributor: HR Research Specialist, Project Assistant, Associate Consultant, Consultant
- Expert Individual Contributor: Chief Scientist, Principal Research Scientist, Principal Consultant, Managing Research Scientist
- Manager: Director of HR Operations, Manager, Team Leader, Program Leader
- Manager of Managers: Area Director of HR, Senior Team Leader, Principal Consultant, Program Director
- Executive: Vice President of HR, Chief HR Officer, Global HR Officer, Director, Executive Consultant, Senior Vice President

Job Titles in Consulting

- Individual Contributor: Project Assistant, Associate Consultant, Professional, Lead Professional, Consulting Associate
- Expert Individual Contributor: Senior Consultant, Senior Professional
- Manager: Manager, Team Leader, Program Manager, Director
- Manager of Managers: Area Director of HR, Senior Team Leader, Principal Consultant, Program Director
- Executive: Director, Officer, Executive Consultant, Vice President, Sr. Vice President, CEO

Geographical:

At the 2025 SIOP Annual Conference, 38 countries were represented, including the U.S.

Top 10 Sending Countries	
1	United States
2	Canada
3	Germany
4	UK
5	Australia
6	Singapore
7	Belgium
8	China
9	Switzerland
10	Hong Kong

Other countries represented (in alphabetical order):
 Brazil, Chile, Denmark, Finland, France, Greece, India, Ireland, Israel, Italy, Japan, Latvia, Malaysia, Mexico, Netherlands, New Zealand, Norway, Pakistan, Poland, Portugal, Puerto Rico, Saudi Arabia, South Africa, South Korea, Spain, Sweden, and Taiwan.

US States With >100 Attendees By % of Total Attendance	
NY	9%
CA	8%
TX	8%
VA	7%
FL	6%
IL	5.5%
CO	5%
GA	4.5%
NC	4%
MN	3.5%
PA	3%
NJ	3%

OH	3%
MI	3%
TN	2.5%

US States With >50 Attendees By % of Total Attendance	
MD	2.4%
WA	2.0%
MO	1.5%
MA	1.5%
OK	1.5%
CT	1.5%
NE	1.5%

Other states represented (in alphabetical order):
 AK, AL, AR, AZ, DC, DE, HI, IA, ID, IN, KS, KY, LA, ME, MS, MT, ND, NH, NM, NV, OR, PR, RI, SC, UT, VT, WI, WY, and WV.

Advertising

2026 SIOP Annual Conference Onsite Guide

Drive attendees to your presentation and booth with an ad in the 2026 SIOP Onsite Guide. The guide will be distributed onsite to all attendees in New Orleans and posted as a downloadable PDF on the conference app.

The 2026 SIOP Onsite Guide will include:

- Daily schedule of all events including plenaries and receptions
- Daily concurrent session grids
- Maps of the conference hotel, convention center, and the Exhibit Hall
- A list of exhibitors and booth numbers
- Continuing education information
- Info on poster sessions and career activities
- Sponsor-recognition page



Submit artwork in 300 dpi in either .JPG or .PDF format by **Wednesday, March 18, 2026**, to graphics@siop.org. The ad artwork file size should not exceed 1 MB.

Ad Space Location	Size	Fee (\$ US)
Inside Front Cover (SOLD)	7.5" W x 10" H or Full Bleed	\$3,750.00
Back Cover (Limit 1) SOLD	8.5" W x 11" H or Full Bleed	\$3,750.00
Full Page	7.5" W x 10" H	\$1,000.00
Half Page	7.5" W x 5" H	\$500.00
Quarter Page	3.75" W x 5" H	\$350.00

SIOP Advertising Policy

The publication of any advertisement by the Society for Industrial and Organizational Psychology (SIOP) is neither an endorsement of the advertiser nor of the products or services advertised. SIOP is not responsible for any claims made in an advertisement. The publications of SIOP are published for, and on behalf of, the membership to advance the science and practice of the psychology of work. SIOP reserves the right to, unilaterally, REJECT, OMIT, or CANCEL advertising which it deems to be not in the best interest of SIOP, the objectives set forth above, or which by its tone, content, or appearance is not in keeping with the essentially scientific, scholarly, and professional nature of its publications. Conditions, printed or otherwise, which conflict with this policy, will not be binding on the publisher.

SIOP Exhibit Hall Photos from 2025 (Denver)



SIOE Exhibit Hall Photos from 2025 (Denver)



Exhibiting

Hall B (1 & 2) in the Ernest N. Morial Convention Center will host the 2026 Exhibit Hall, SIOB Commons, and Poster Sessions.

Paramount Convention Services (PCS) of St. Louis, MO, is the General Services Contractor. Contact them for booth cleaning, carpet, floral, furniture, and materials handling. Contact Leigh Everett at leveret@paramountcs.com or (314) 621-6677 with questions. Online ordering can be found at www.paramountcs.com/exhibitorservices.

The 2026 SIOB Exhibitor Service Kit, which will be emailed by Susan Rogers to the individual(s) who ordered the booth.

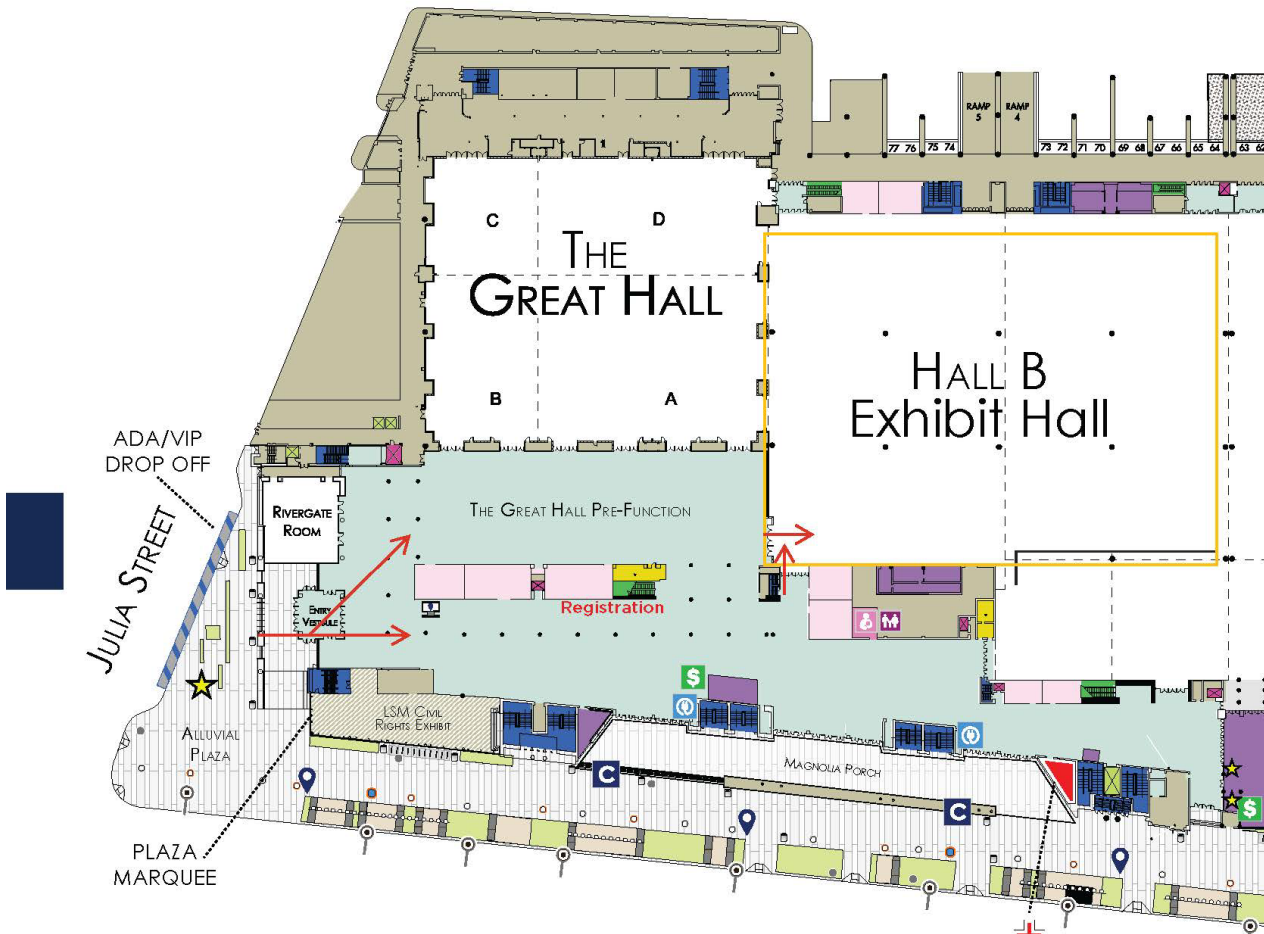

2026 Exhibit Hall Key

Yellow=20' x 30'

Purple=20' x 20'

Blue=10' x 20'

Green=Premium-Location 10' x 10' White=Standard 10' x 10' Orange=SIOP Booth

As of 02/12/2026. Visit <https://www.siop.org/events/the-annual-conference/partners/partner-program/exhibiting/floorplan/> for updates.

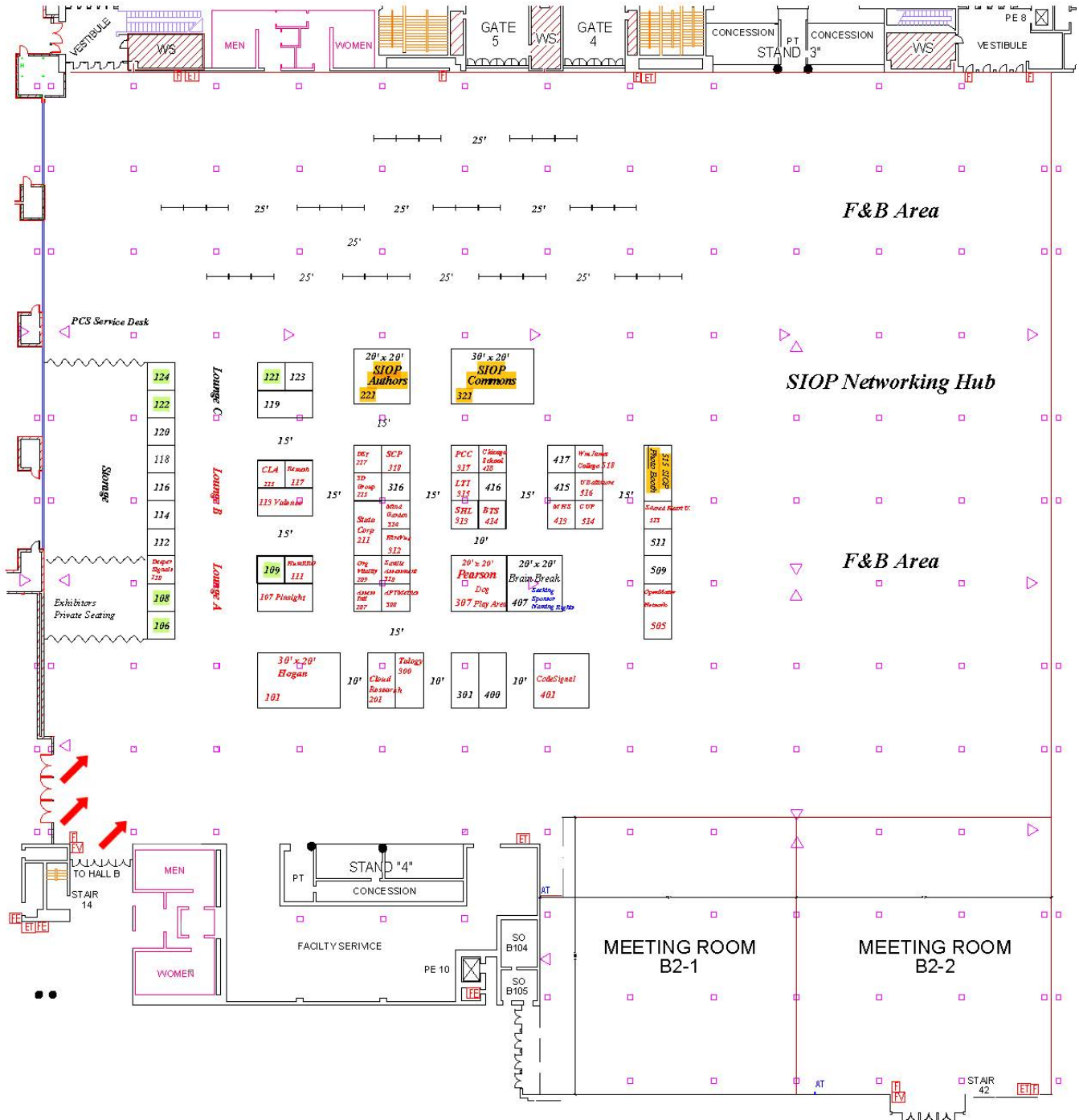

Booth Sizes & Pricing

Booth Type	Description	Fee (\$US)
Exclusive XL Exhibit Booth	One 20' deep by 30' wide booth	\$23,250
Elite XL Exhibit Booth	One 20' deep by 20' wide booth	\$15,500
Triple Exhibit Booth	One 10' deep by 30' wide booth	\$10,585
Double Exhibit Booth	One 10' deep by 20' wide booth	\$6,990
Premium-Location Exhibit Booth	One 10' deep by 10' wide booth in a higher traffic location within the exhibit hall	\$3,495
Standard Exhibit Booth	One 10' deep by 10' wide booth in the exhibit hall	\$2,495
Virtual Booth Only	Conference App Only	\$1,495

Each exhibit booth purchase includes:

- 8' back drape and 3' side drape (black)
- one (1) 6' x 30" draped table (white top, black skirt)
- two (2) padded side chairs
- one (1) wastebasket
- one (1) ID sign

Show colors: Black Aisle Carpet Color: Bluejay

Your booth purchase does not include flooring or carpet. Flooring or carpeting is mandatory for each booth.

Booth Space Selection & Ordering Process:

All orders are taken and sales completed by email. Contact Susan K. Rogers, CAE, at srogers@siop.org.

Booth Preference:

In your email, please indicate up to three preferred locations by booth number in case your first choice is no longer available. SIOP reviews all booth-location preferences and considers the date the order was placed, the level of partnership support, and prior partnership history when making booth-assignment decisions. Attempts will be made to honor requests for preferred booth locations, but it may not be possible.

Subject to Change:

Although we share our planned location for features in the exhibit hall, such as main entrances, coffee breaks areas, the SIOB Commons, and the poster sessions, as well as sponsored signage, it is possible these locations could change due to state and local legal requirements, venue requirements, and/or fire and safety restrictions or to meet adjustments to conference plans.

All invoices must be paid in full by **April 1, 2026**, or your participation in the conference is subject to cancellation.

AV Services:

Information to be determined. If you have questions about exhibitor AV, please contact Seamless Event Solutions at rfp@seamless.com

Carpet:

The Exhibit Hall floor is NOT carpeted. The floor is cement. Carpeting or flooring in your booth is mandatory. You can purchase flooring or carpeting and padding for your booth through the 2026 SIOB Exhibitor Service Kit or you can ship your own to the show. Standard carpet for a 10' x 10' booth is \$320. The aisle carpet will be a blue and black standard carpet.

Electrical:

You may purchase electrical separately from the convention center. Electrical in your booth is not mandatory. If you have questions about exhibitor electrical, please contact exhibit_services@mccno.com or 504-582-3036.

Food & Beverage:

All food and beverages served in your booth, including coffee and wine, MUST be purchased from Sodexo Live! Go to mccnoexpresscatering.ezplanit.com. Search and select the SIOB event. The deadline to order is April 15, 2026, by 5 PM Central.

If you have questions about exhibitor food and beverages, please contact:

- Amanda Rivero, Affiliate/Exhibitor Catering Sales Manager, at (504) 670-1492 or amanda.rivero@sodexo.com.
- Please cc Emily Marchand, Catering Sales Manager, at emily.marchand@sodexo.com on all your email communications.
- The main phone number for Sodexo Catering in New Orleans is (504) 670-7200.

Furniture Rental:

Standard and Specialty Furniture can be rented by exhibitors from Paramount Convention Services through the 2026 SIOP Exhibitor Service Kit. Contact Paramount Convention Services for pricing.

Lead Retrieval:

Exhibit booth staff will be able to scan attendee badges using a feature on the conference mobile app.

In order for your staff to use this feature on the conference app, each person needs to be identified as an “exhibitor” in the conference app (which turns this function on for them). Attendees not identified as exhibitors cannot see or use this function on the app.

Staff members who will only be working in the booth need an “exhibit hall only” type badge. The “exhibit hall-only” type badge does not allow the wearer to attend educational programs, attend conference receptions, or participate in conference coffee breaks or meals.

Contact Susan K. Rogers, CAE, at srogers@siop.org with the names of your booth staff by April 1, 2026.



A staff member who registered to attend the conference can gain access to the exhibit hall during times when it is closed to attendees—such as to help set-up or pack-up the booth—with the addition of an “Exhibitor” icon to their attendee badge. This icon is added to the attendee badge electronically.

Please identify these attendees by **April 1, 2026**, so that their attendee badge only needs to be printed once.

NOTE: If an attendee wishes to work in the booth when the exhibit hall is open to attendees, they do not need the “exhibitor” icon on their badge. The icon only provides access to the exhibit hall when it is closed to regular attendees.

Shipping:

Please check the 2026 SIOP Exhibitor Service Kit for more details. Exhibitors may ship materials up to 30 days (April 1, 2026) in advance of the show. The Advanced Receiving Deadline is Monday, April 20, 2026.

Your Company Name & Booth #
c/o Paramount Convention Services
ABF
400 Shrewsbury Rd,
Jefferson, LA 70121, US
Atten: SIOP Annual Conference

Wi-Fi:

Wi-Fi in the Exhibit Hall will be shared bandwidth among exhibitors and attendees. If you need reliability and high speed for in-booth product demonstrations and videos, we recommend that you purchase a dedicated Internet line for your booth through the convention center's Technology Services.

Contact them at technology@mccno.com or call (504) 582-3095.

More information about MCCNO Exhibitor Services can be found on the MCCNO website:

<https://mccno.com/exhibitors/services>

Contact: exhibit_services@mccno.com or (504) 582-3036.

Enhance Your Exhibit & Save Money:

Visit [Exhibitor](#) magazine's website and go to their "Articles by Topic" area for articles on how to enhance and save money on your booth design and shipping as well as how to prepare and train staff. Go to exhibitoronline.com.

Looking for a location in New Orleans for a private event for clients? Check out uniquevenues.com for location ideas or contact the Visitors and Convention Bureau.

2026 Exhibit Hall Schedule:

Wednesday April 29	Exhibit Hall Set-Up: Hall B, MCCNO 8 to 4 PM Central	Exhibit Hall Set-Up of All Booths <i>Booth Set-Up Must Be Complete by 4:00 PM!</i>
Thursday April 30	Open: 8 to 5 PM Central	The exhibit hall will remain open during the lunch break from 11:30 AM to 1 PM. Concession lunches will be available.
Friday May 1	Open: 8 to 5 PM Central Closed: 5 to 7 PM	The exhibit hall will remain open during the lunch break from 11:30 AM to 1 PM. Concession lunches will be available. Exhibit Hall Tear Down

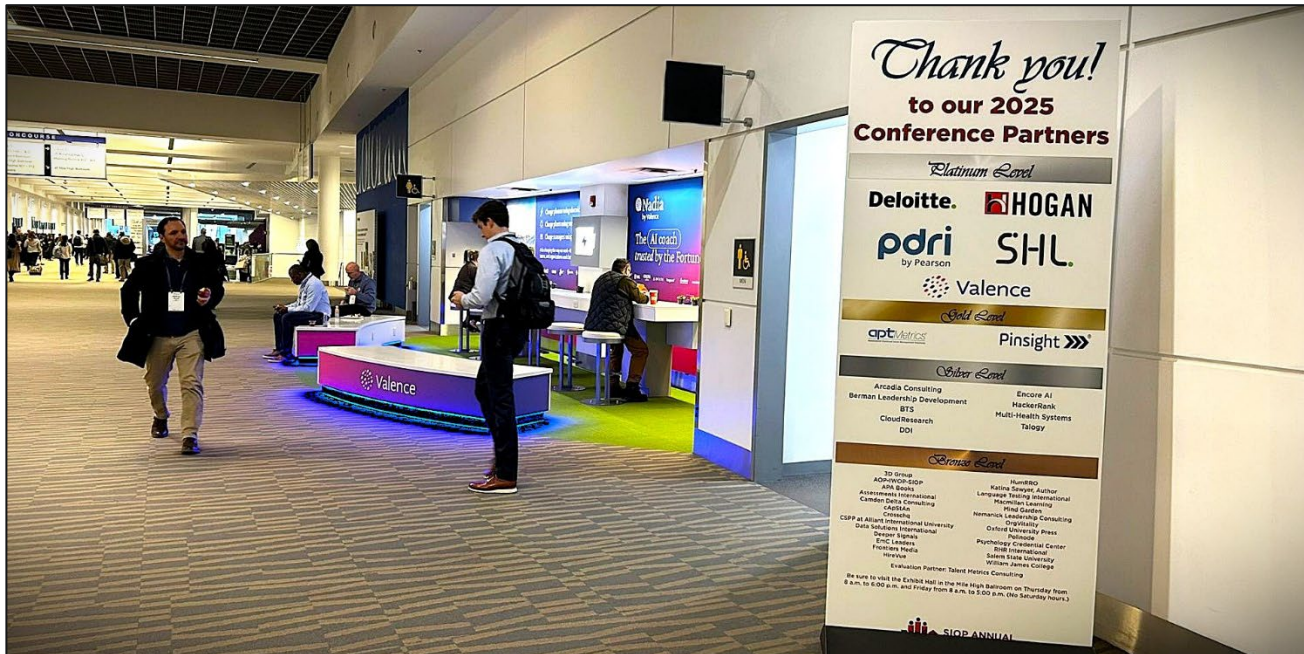

“Exhibit Hall-Only” vs “Attendee” Registrations:

Type of Registration	Intended For	Description	Fee	What Is Included	What Is NOT Included
“Exhibit Hall-Only” Registration Type	Booth Staff	SIOIP recommends up to four (4) “exhibitor hall-only” registrations per 10 x 10 booth space purchased.	\$0	Provides the individual with access to the exhibit hall during set-up and tear-down and when the hall is closed to attendees.	An individual with this badge type may NOT attend the opening, plenary, the educational sessions, or receptions, nor may they partake in what is offered at coffee breaks or meals.
Attendee Registration Type	Conference Attendee	This is for individuals who are attending the conference. They are allowed to work in the booth during regular exhibit hall hours.	See the Annual Conference Registration web page for member vs. non-member registration fees. Register during the early bird for the lowest price.	Includes the opening plenary, all educational sessions breaks, meals, and receptions but does not include workshops, Consortia, Research Community Forums, & Friday Seminars.	An attendee badge does NOT provide access to the exhibit hall during set-up and tear-down and when the hall is closed to attendees.



If someone has an “exhibit hall-only” badge (aka a booth-staff badge) and they wish to also attend educational sessions and/or receptions, then they need to register to attend the conference and pay the appropriate (member vs. non-member) fee. In the end, they will have an attendee badge but with an exhibitor icon on it, which will give them access to the exhibit hall during non-attendee hours.

Someone with an attendee badge may NOT enter the exhibit hall during set-up or tear-down or when the hall is closed to attendees. If they need access to the exhibit hall during those times, then they also need an “exhibit hall-only” type registration.

Someone with an attendee badge may work in their organization’s booth during regular exhibit hall hours without requiring an exhibit hall-only badge.

Appendix A: 2025 Sending Organizations

3D Group
3G Leadership Solutions
3M
A.Y. McDonald Industries
A2M Partners
AAA Auto Club Group
AAMC
Abbott
AbbVie
Acadia Healthcare
Accenture
Action for the Climate Emergency
ADP
Adsum Insights
Advanced Sterilization Products
Advisa
Advocate Aurora Health
AE Strategies
Affirmity
AgAmerica
Agile HR Tech
Ahold Delhaize
AIIR Analytics
AIIR Consulting
Akron Children's Hospital
Albertsons Companies
Aliniti LLC
Allstate
Alpha Omega Associates
ALPS Insights
Alto Impacto
Amazon
American Board of Internal Medicine
American Family Insurance
American Nurses Credentialing Center
AMOpportunities
Anderson Center for Autism
Angela R. Howard Consult
Angi's List
Ann & Robert H. Lurie Children's Hospital
Anna Kallschmidt, LLC
Aon
APA
Apple
Applied Personnel Research
Applied Sciences
Aptima, Inc.
APTMetrics
Aqua Finance
Arcadia Consulting
Argo ai
Ascenditur Inc.
ASenior Consulting
Asselmointi Oy
Assessment Associates International
Assessments International, Inc.
AT&T
Atana
Ateliê RH
Atlassian
Avelle Strategies
Avionica, LLC
Aya Healthcare
Bank of America
Barry-Wehmiller Design Group
Basil Consultants
Bath & Body Works
Be More Human
Behavioral Research Solutions
Berkeley Research Group, LLC
Berkshire Associates
Berman Leadership Development
BetterUp
Bittner and Associates, LLC
Black & Veatch
BlackRock
Block
Block, Inc.
Blue Psynergy Consulting, LLC
Boehringer-Ingelheim USA, Inc.
Boeing
Bolton Talent
Booz Allen Hamilton
Brevard Health Alliance
Brio Performance Solutions
Bristol Myers Squibb
Brock Group
Bryq
BTS
Buros Center for Testing
C Evans
CAC Industries Inc.
CACI
Camden Delta Consulting, LLC
Capella Space
Capgemini
Capital One
Capri Holdings (Michael Kors, Jimmy Choo, Versace)
cApStAn SA
Carilion Clinic
Cassia High School
Catalyst Inc
Catalyst International
Caterpillar Inc.
CCO Certification
Cedars Sinai
Cellular Sales
Center for Creative Leadership
Central Health
Central Health & Travis County Hospital
Centurion Health
CenturyLink
Cerner
CH Robinson
Chapman & Co Leadership Institute
Charles Schwab
Chevron Corporation
Chewy

Chick-fil-A
 Children's Hospital at Dartmouth
 Children's Nebraska
 Christmasdesigners.com
 CIBC
 Cincinnati Children's Hospital & Medical Center
 Cincinnati Insurance Companies
 Cisco Systems
 Citi
 Cloudflare
 CloudResearch
 CMA
 CMA Global Inc.
 Coachability Consultants
 Coalition Coaching & Consulting
 CodeSignal
 Codility
 Colorado Springs Utilities
 Community Interface Services
 Compass Consultoria Organizacional
 Compass Mining
 Conexus MedStaff
 CONMED
 Connect Coaching & Consulting
 Connected Commons
 Consultant
 Contemporary Leadership Advisors
 Conway Regional Health System
 Core Consulting and Coaching, LLC
 Coreflection
 Corey's Network, A Foundation for Hope
 Corning, Inc.
 Corvirtus
 Cox Automotive
 Cox Communications
 Cox Enterprises, Inc.
 CPS HR Consulting
 CRAI
 Creating Open Space, LLC
 Criteria Australia
 Criteria Corp
 Crosschq
 Cultivate
 Culture Amp
 CultureFactors, Inc.
 Curphy Leadership Solutions
 CVS Health
 D.E. Shaw
 Danone NA
 Dassault Systèmes
 Data Solutions International
 Dayforce
 DCI Consulting Group
 DCS Corp, Infoscitex Sector
 DDI
 De Meuse Leadership Group
 DE Shaw Group
 DeBakey VA Medical Center
 Deeper Signals
 Dell Technologies
 Deloitte
 Delta Air Lines
 Delta Dental
 DesignForce
 Dick's Sporting Goods
 Discover Financial Services
 Discovery Talent Strategies
 DISH Network
 DJ O'Donnell Co.
 Dow Company
 Dow Inc.
 Dr Steach LLC
 Drakesmith Consulting
 DropBox
 Duncan Aviation
 Duolingo
 E Business Consultants LLC
 E. Rogers Associates
 Eaton
 eBay
 Edelman
 EDF Renewables
 Edison Electric Institute
 Educational Testing Service
 Edward Jones
 EEI
 EEOC
 EG America
 Electronic Arts
 Eli Lilly & Company
 embecta
 EmC Leaders Inc
 Emerson Electric
 Emerson Electric
 Emoty Health USA
 Enbridge
 Encore AI
 Encore Intelligence Inc
 Energage
 Energis, Ltd.
 Engage2Excel
 Envisia Learning
 EP Coaching & Consulting
 Equinix
 Equity LifeStyle Properties
 Ernst & Young
 ESCI
 Excelis Leadership Consulting, Inc.
 Executive Advisory Services of JPA International, Inc.
 Executive Development Group LLC
 Executive Leadership Partners, LLC
 Executive Leadership Strategies, LLC
 Exelon Corporation
 Experian
 ExperiencePoint
 Extra Space Storage
 EY
 Facebook
 Facteau & Associates, LLC
 FairNow
 Fairsight
 Fannie Mae
 FedEx Logistics
 Feels Human, LLC
 Ferdman Consulting
 FiDelis Talent Solutions

Fidelity Investments
 FINRA
 First Domino Consulting
 Flagship Pioneering
 Flexible Work Solutions
 FlowRx
 FLUXIFY
 FMP Consulting
 Foot Locker, Inc.
 Ford Motor Company
 Foremost Farms USA
 Fors Marsh
 Forvia
 Fractional Insights
 Fresenius Medical Care
 Frontiers Media
 Future of Work Project
 Gallup Organization
 Gartner
 GE Aerospace
 Genentech
 General Mills
 General Motors
 GeniusMesh
 GetSense.net
 GHD, Inc.
 Gilead Sciences
 GlaxoSmithKline
 GoHealth Urgent Care
 Goldman Sachs
 Good Works Consulting
 Goodness of Psychology Ltd
 Goodwill Industries of Southern AZ
 Goodyear Tire & Rubber Company
 Google
 Gotham Leadership Consulting
 Gothic Landscape
 Granite Construction
 Grant Thornton
 Green Plains Energy
 Green Sky Leadership
 Greenmeadow Group
 Gresham Smith
 Greystar
 Guardian Life
 HackerRank
 Half Moon Consulting
 HARMAN International
 Harris Health System
 Harver
 Harver
 Hehn Consulting
 Heidrick & Struggles
 Hesion Leadership Consulting
 HiBob
 Hicks-Carter-Hicks
 Hilton
 Hire Point Consulting, LLC
 HireVue
 Hogan Assessment Systems
 Home Depot
 Honeywell
 Hooper Curtis Marketing
 HORNE
 HP
 HRCatalyst, Inc.
 HRTec
 HUB International
 HUCAMA Analytics Ltd
 Hudec Consulting
 HueLife
 Human Measures
 Humana
 Humancore
 HumRRO
 Huron Consulting Group
 Hutchison Consulting, LLC
 IBM
 IGT
 Illumina, Inc.
 Inclusion-Analytics
 Individual Differences at Work, LLC
 Industrial/Organizational Solutions, Inc.
 Infineon Technologies
 Infor
 Infocitex, a DCS Company
 Insight Business Works
 Insight222
 Insights 2 Action Group
 Institute for Organizational Behavior Research
 INTALENTSIGHT, SLU
 INTEGRITAS
 Intel Corporation
 Intelligent Coaching & Consulting Inc.
 Interpublic Group
 Intersections Consulting Group
 Intuitive Surgical
 Inubilum
 ioPredict, Inc.
 IOS, Inc.
 I-OSolutions, Inc
 Iron Post Leadership
 ITC Holdings
 Itron
 Ivy Planning Group
 Jackson Lewis, P.C.
 JD Irving Limited
 JES Tech
 JetBlue
 JHT, Inc.
 JM Ward Consulting
 John Deere
 Johnson & Johnson
 JP Morgan Chase
 JPI Consulting
 JumpCloud
 Kaiser Leadership Solutions
 Kaizen Approach
 Kaya Consulting Pty Ltd
 KBR - NASA
 Kenco Group
 Kenvue
 KeyBank, NA.
 Kincentric
 Klaviyo
 Knockri

Koch Capabilities, LLC
 Kohler
 Korn Ferry
 KPMG
 Language Testing International
 Lanier Leadership
 LDW
 Leadership Alliance
 Leadership Excellence Consulting
 Leadership Research Institute
 Legvold Consulting
 Leidos
 Lennar
 Lenovo
 Lewis-Burke Associates LLC
 LHH
 Liberty Mutual
 Life Source Training Institute, Inc.
 Lifepoint Health
 LifeTime
 Lightcast
 Limeade
 LinkedIn
 LinkVisum Consulting
 Littler Mendelson, PC
 Liv HR Consulting LLC
 Living Spaces
 LMI
 Lockheed Martin
 LOMA
 London Stock Exchange Group
 L'Oreal
 Lotis Blue Consulting
 LTI
 Luck Companies
 Maestro Consulting, LLC
 Management Research Group
 ManpowerGroup
 Markem-Imaje
 Marriott International
 Marsh & McLennan Agency
 Mattingly Solutions
 McAfee
 McKee Foods
 McKinsey & Company
 MD gesellschaft für management-diagnostik mbh
 Medtronic
 MedVet
 Melwood, Inc.
 Memorial Sloan Kettering Cancer Center
 Menlo
 Mento
 Mercer
 Mercer | Sirota
 Merck
 Meta
 Metra
 MFS Investment Management
 MHS
 Microsoft
 Microsoft Viva Glint
 Mile Twenty Consulting
 Mind Garden
 Mindsight
 Minerva Psychology Ltd
 Minerva Work Solutions, PLLC
 Ministry of Defence Singapore
 MiTek, Inc.
 Mix Talent
 MK Business Psychology
 Modern Executive Solutions
 Modern Hire-A HireVue Company
 Molson Coors
 Morris & McDaniel, Inc.
 MRG Assessments
 MU Research Institute
 Multi-Health Systems, Inc.
 Mustang CAT
 Nancy T. Tippins Group
 Nassau Suffolk Law Services
 National Veterinary Associates
 NBC Universal
 ND Visionary Partners
 Nebraska Medicine
 Nemanick Leadership Consulting
 Nestlé USA
 NetApp
 Netflix
 New Balance
 New Beginnings
 New Heights Consulting
 Newmeasures LLC
 Newport Healthcare
 Next Conversation Consulting
 Nike
 Nissan
 Nordstrom
 Northrop Grumman
 Northwell Health
 Novartis
 O*NET Development Center
 OccPsyence Limited
 Ocean Spray
 Oculus Inc.
 Ocular, Inc.
 OED District
 One Model
 Operational Technologies
 Org Empathy Consulting, LLC
 Organizational Research & Solutions, Inc.
 Organizational Strategies
 Organon & Co.
 OrgVitality, LLC
 Orgvue
 ORS Impact
 Otsuka Pharmaceutical Companies- US
 Outten & Golden LLP
 Owens Corning
 Oxford University Press
 Pacific Dental Services
 Palo Alto Networks
 Paradox
 Paris Phoenix Group
 Parkland
 Parkway Corporation
 Partners Health Management

Paul C. Green PhD LLC
 PBJ People Consulting & Coaching
 PDRI by Pearson
 Pearson
 Pearson VUE
 Penske
 Penske Transportation Solutions
 Penske Truck Leasing
 People Person, LLC
 People Science & Strategy LLC
 People Strategies
 PepsiCo
 Perceptyx
 Performance Insight
 Permanente Medical Group, Inc.
 Perpara Consulting, LLC
 Phenom
 PIMCO
 Pineapple Healthcare
 Pinnacle Group Australia
 Pinsight
 Plan to Action
 Platform Aerospace
 PMA Companies
 Polinode
 Praxis Labs
 PriceSenz
 Princeton HR Insight LLC
 Private Consultant - Legacy Psychology
 ProActive Consulting
 Procter & Gamble
 Prodigie
 Professional Equity Management
 Progressive Insurance
 Prologis
 Propulo Consulting
 Prudential Financial
 PS
 Psych AB Assessments and Counseling Inc.
 Psychology Credential Center
 Publix Super Markets, Inc.
 Purposeful Growth & Wellness
 PVH Corp.
 PwC
 pymetrics
 Quality of Life Laboratory
 Qualtrics
 RAC Leadership
 Raines International
 RAND Corporation
 Ranier Leadership Solutions
 Ray Stone Incorporated
 Raymond James
 Recruit Management Solutions Co., Ltd
 Red Bull
 Red Hat
 Regal Rexnord
 Regeneron
 Remesh.ai
 Renaissance Learning
 Residual Consulting
 Resilience Alliance
 Resolution Economics
 Rev O LLC
 Rhabit Analytics
 RHR International
 Ridley & Associates
 Right Management
 Riot Games
 RiseOn
 Robert Half International
 Roblox
 Roche
 Rock and Secure LLC
 Rocket Companies
 Rocket-Hire LLC
 Rohde Consulting
 Rollins Inc.
 RoviSys
 RTI International
 Russell Reynolds Associates
 S&P Global
 Sage Consulting Resources
 Salesforce
 San Diego Gas and Electric
 San Francisco Public Utilities Commission
 San Mateo County
 Sanderson Farms
 Sanofi
 Sanoma
 SAP SuccessFactors
 SC Johnson
 Scania Argentina
 Scheu Talent Consulting Services LLC
 Schmidt Harvey Consulting, LLC
 Scontrino-Powell
 S-Culture
 Seadrill
 Seity Insight
 Semperis, Inc.
 ServiceNow
 Seyfarth Shaw LLP
 SharkNinja
 Sherwin-Williams Company
 SHL
 SIGMA Assessment Systems
 SKS Consulting Group
 Snowflake
 Sonova Group
 Sotera Health
 Southern Glazer's Wine & Spirits
 Southern Veterinary Partners
 Spellman High Voltage Electronics Corp.
 Spencer Stuart
 Splunk
 Springer Nature
 St. Jude Children's Research Hospital
 Stanard & Associates
 Starbucks
 State Farm
 Stealth Startup
 Steffensmeier Talent Consulting LLC
 Strategic Mixtape
 Strategic Talent Solutions, LLC
 Strategies for Effective Teamwork, LLC
 Stripe

Stryker
STS
SuccessFinder
Suited
Summit Leadership Partners
Summit Materials
Super Retail Group Ltd
SupplyHouse.com
SwAF
Sycamores
Symeta Behavior Science
Systems Planning and Analysis
T. Rowe Price
Takeda Pharmaceuticals
Talent Algorithms Inc
Talent Metrics Consulting
Talent Select AI, LLC
Talent Strategy Group
TalentNeuron
Talogy
Tampa General Hospital
Target
Taylor-Made Strategies
Terumo Neuro
Teva
Textio
The Aldridge Group
The Bancorp Bank
The Buckle, Inc.
The Building People
The C Suite Collective
The Christ Hospital Health Network
The Coca-Cola Company
The C-Suite Collective
The Expert Circle
The Group for Organizational Effectiveness
The Guitar Center Company
The Leadership Effect
The Myers-Briggs Company
ThreeFish Consulting
Thrivent
TIAA
TikTok
time:matters
TMLeadership Solutions, LLC
T-Mobile
Tower & Company
Tower Health
Tractor Supply Co
Training Industry, Inc
Trane Technologies
Transcend
TRIBE Insights, Inc
Trimble, Inc.
Tripler Army Medical Ctr
University of the Health Sciences
TRS
Truist Leadership Institute
TruScore
TruthSpeaksGroup LLC
TSP, a Syneos Health Company
TTCU Federal Credit Union
TTS-Top Talent Solutions

Turing.com
Turner & Townsend
Turner Construction
Twitter
TWMason
Uber Technologies, Inc.
UCLA Health
Udemy
UKG
United Airlines
United States Steel
Unum
UT Health San Antonio
UT MD Anderson Cancer Center
Valence
Valero
Valmont Industries
Vandaveer Group, Inc
Vanessa Vershaw Group
Vantage Leadership Consulting
Vaya Group
Venegas Construction Corp.
Verizon
Vero AI
Vetor Editora
VF Corporation
Victaulic
Victoria's Secret & Company
Violet Group
Viridien
Visa
Visier
Vmark Consulting
VML
VMware
Volkswagen Group of America
W.W. Grainger, Inc.
Walmart
Walt Disney
Warner Bros. Discovery
Wayfarer Group LLC
WECO Solutions
Welliba
Wells Fargo
Wellstar Health Systems
Wendal, Inc.
WestRock
Willis Towers Watson
Wipfli LLP
WiseUp Coaching & Consulting
Wonder
Wonderlic
Workday
Workforce Science Associates
Workforce Sciences Institute
Workhuman
Worklytics
WorkMaru
Workplace Dynamics LLC
Workr Beeing
Written, LLC
WTW
XTalent Consulting Co., Ltd

Yext
Your Trusted Advisors
YSC Consulting

Zendesk
Zillow Group
Zwift

2025 Sponsor Photos (Denver)

SAMPLE ONLY. Below are photos of typical sponsorship opportunities at our conference, such as lanyard sponsor, charging station sponsor, standing signage (SEG fabric wall), and glass cling signage.

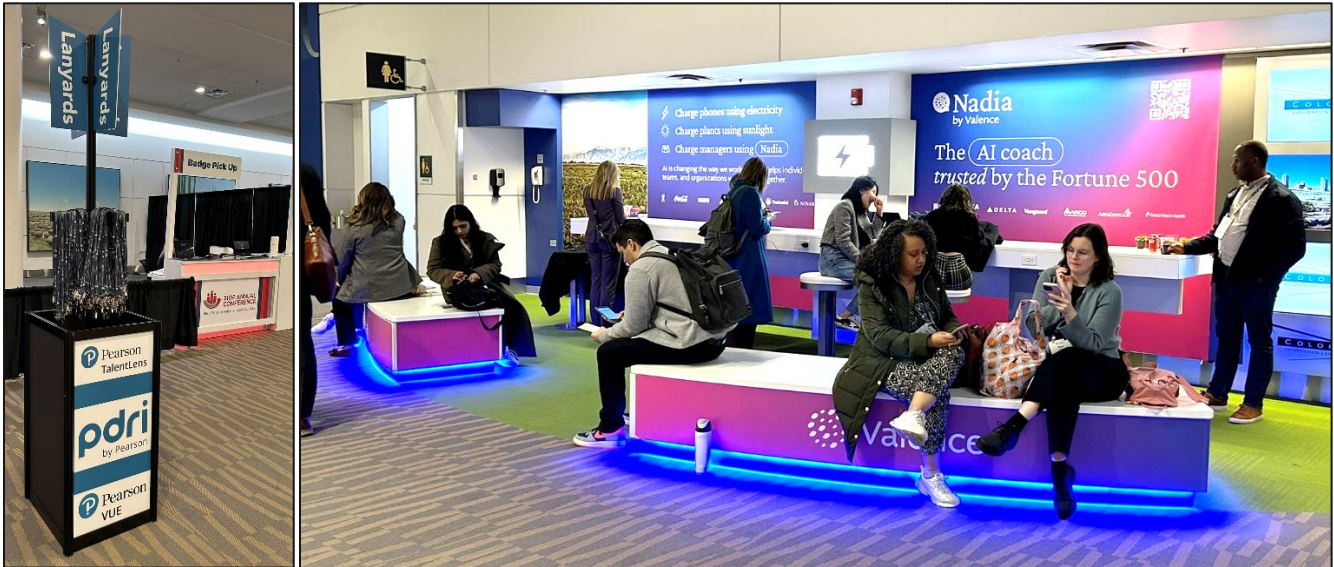

2025 Sponsor Photos (Denver)

Other sponsorship opportunities at our conference include lounges, four-sided freestanding boxes, ceiling banners, and wall clings.

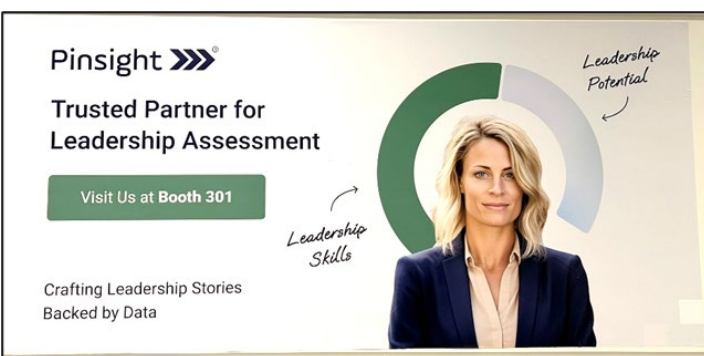
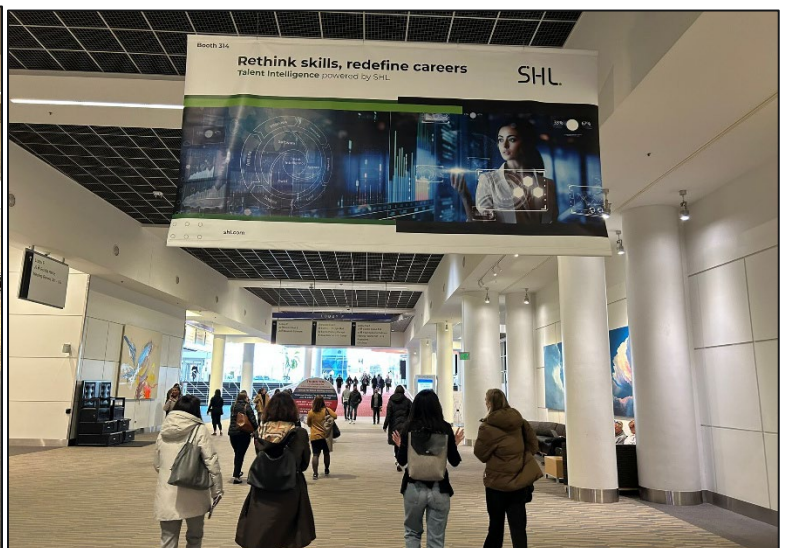
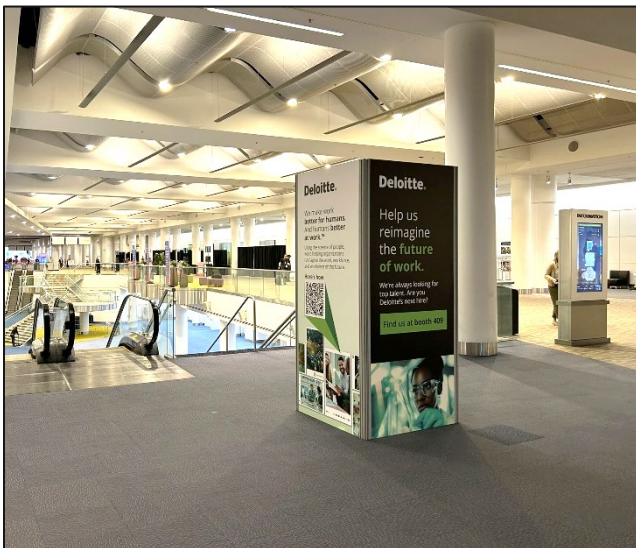
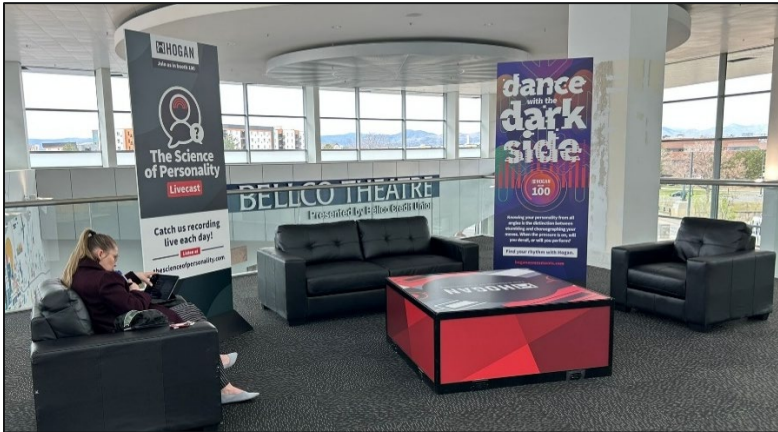

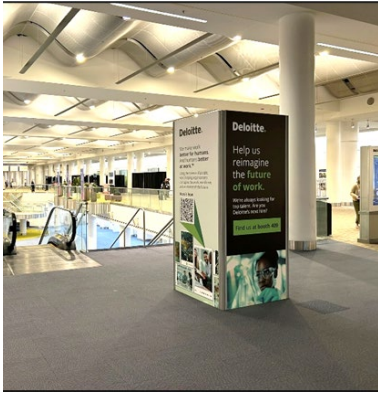

What is a BeMatrix Box?

The BeMatrix Modular Frame System provides a solution for just about any structure you can imagine. The system is based on aluminum weight-bearing structure on to which you can attached fabric and hard panels. The frames go together quickly and without any special tools or technical equipment. Many companies also use BeMatrix systems for the structure of their booths.



What is a Meter Board with Hoffa Base?

Meter boards are self-standing advertisement displays that are made from ½” thick foam core and include a base for stability. When designing your meter board, please keep the design near the base simple. Your message should be from the top to the middle. Use the bottom half for color and design only. A Hoffa base (shown on the left) is sturdier than two foam-core feet.



What is a SEG Fabric Wall?

A SEG fabric wall is a display system that uses Silicone Edge Graphics (SEG) to create a seamless, frameless appearance. The fabric graphic has a thin silicone strip sewn around its edges, which is then inserted into a groove in a custom aluminum frame. This creates a tight, drum-like tension on the fabric, resulting in a clean, modern, and edge-less look.



SIOP ANNUAL CONFERENCE

NEW ORLEANS • April 29–May 2, 2026

ARTWORK DEADLINES & GUIDELINES

Paramount Convention Services will provide the printing & installation of your sponsored signage.

Artwork Deadline: COB March 18, 2026

After March 27, PCS will add a 3% surcharge per day to artwork production, which will be charged to the sponsor.

Sending Files

- Send artwork to to **graphics@siop.org** for initial review on or before March 18, 2026. The earlier the better.
- Please send all graphics as print ready PDF(200dpi+) with NO BLEEDS.
- Make sure all fonts are outlined and all images are linked/embedded.
- If you send a file at something other than 100% please make a note of this when sending your files.
- SIOP will upload your proofed artwork to Paramount Convention Services.

If you have any other questions or concerns regarding sizing or graphics production, please contact Craig Kleine at Paramount Convention Services.

314.680.2084 or craig@paramountcs.com

New Orleans Ernest N. Morial Convention Center

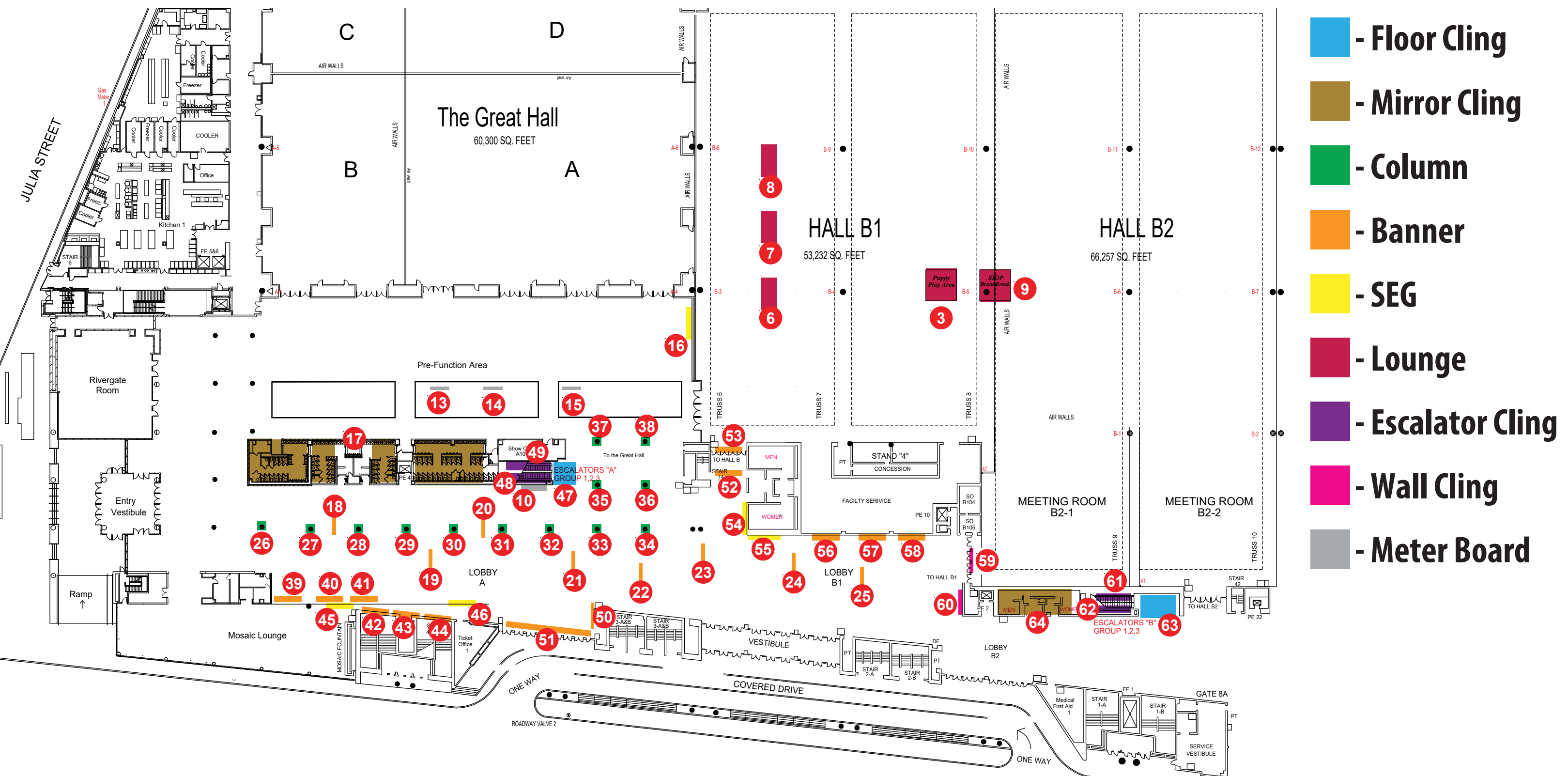

Sponsorships

Opp #	Qty	Avail	Fee (USD)	Description	Location	Size
1	14	9	\$5,000.00	Partner Showcases/Tech Demos	Educational Session Room	N/A
2	1	0	\$15,500.00	Lanyard & Lanyard Holders	Reg-Area	N/A
3	1	0	\$12,500.00	Dog Petting Booth	Exhibit Hall	20' x 20'
4	1	1	\$10,000.00	Thursday Session Partner	Digital	N/A
5	1	1	\$8,000.00	Friday Session Partner If Thurs Purchased	Digital	N/A
6	1	1	\$7,500.00	The Boulevard Mini Lounge A	Exhibit Hall	10 x 20 Lounge Area
7	1	1	\$7,500.00	The Boulevard Mini Lounge B	Exhibit Hall	10 x 20 Lounge Area
8	1	1	\$7,500.00	The Boulevard Mini-Lounge C	Exhibit Hall	10 x 20 Lounge Area
9	1	1	\$6,000.00	Brain Break Booth	Exhibit Hall	20' x 20'
10	1	0	\$500.00	Ribbon Wall	Reg-Area	N/A
11	1	1	\$3,500.00	Newcomer Reception	TBD	TBD
12	0	0	\$3,000.00	Frank Landry Fun Run	TBD	TBD
				Great Hall Prefunction (GHP)		
13	1	1	\$1,250.00	Two-Sided Meter Board A	GHP	38"x96" DS
14	1	1	\$1,250.00	Two-Sided Meter Board B	GHP	38"x96" DS
15	1	1	\$1,250.00	Two-Sided Meter Board C	GHP	38"x96" DS
16	1	1	\$7,500.00	Great Hall Prefunction SEG Wall Panel (near Exhibit Hall entrance)	GHP	116.625" W x 94.9375" H
17	1	1	\$1,750.00	Great Hall/Lobby A Men's & Women's Restrooms Mirror Clings (27 total)	Lobby A	8" W x 8" H
				Lobby A		
18	1	1	\$3,750.00	Lobby A Ceiling Banner BDU PH1-BR1	Lobby A	10' W x 8' H
19	1	1	\$3,750.00	Lobby A Ceiling Banner BDU PH1-WS1	Lobby A	10' W x 8' H
20	1	1	\$3,750.00	Lobby A Ceiling Banner BDU PH1-BR2	Lobby A	10' W x 8' H
21	1	1	\$3,750.00	Lobby A Ceiling Banner BDU PH1-WS2	Lobby A	10' W x 8' H

Opp #	Qty	Avail	Fee (USD)	Description	Location	Size
22	1	1	\$3,750.00	Lobby A Ceiling Banner BDU PH1 BR3	Lobby A	10' W x 8'H
23	1	0	\$3,750.00	Lobby B1 Ceiling Banner BDU PH1 WS3	Lobby B1	10' W x 8'H
24	1	0	\$3,750.00	Lobby A Ceiling Banner BDU PH1 BR4	Lobby B1	10' W x 8'H
25	1	1	\$3,750.00	Lobby B1 Ceiling Banner BDU PH1-WS4	Lobby B1	10' W x 8'H
26	1	1	\$5,000.00	Lobby A Column 2 BeMatrix Box-4 Sided	Lobby A	38.875 W x 94.9375 H
27	1	1	\$5,000.00	Lobby A Column 3 BeMatrix Box-4 Sided	Lobby A	38.875 W x 94.9375 H
28	1	1	\$5,000.00	Lobby A Column 4 BeMatrix Box-4 Sided	Lobby A	38.875 W x 94.9375 H
29	1	1	\$5,000.00	Lobby A Column 5 BeMatrix Box-4 Sided	Lobby A	38.875 W x 94.9375 H
30	1	1	\$5,000.00	Lobby A Column 6 BeMatrix Box-4 Sided	Lobby A	38.875 W x 94.9375 H
31	1	1	\$5,000.00	Lobby A Column 7 BeMatrix Box-4 Sided	Lobby A	38.875 W x 94.9375 H
32	1	1	\$5,000.00	Lobby A Column 8 BeMatrix Box-4 Sided	Lobby A	38.875 W x 94.9375 H
33	1	1	\$5,000.00	Lobby A Column 9 BeMatrix Box-4 Sided	Lobby A	38.875 W x 94.9375 H
34	1	1	\$5,000.00	Lobby A Column 10 BeMatrix Box-4 Sided	Lobby A	38.875 W x 94.9375 H
35	1	1	\$5,000.00	Lobby A-GH Column 11 BeMatrix Box-4 Sided	Lobby A	38.875 W x 94.9375 H
36	1	1	\$5,000.00	Lobby A-GH Column 12 BeMatrix Box-4 Sided	Lobby A	38.875 W x 94.9375 H
37	1	0	\$5,000.00	Lobby A GH Column 13 BeMatrix Box-4 Sided	Lobby A	38.875 W x 94.9375 H
38	1	1	\$5,000.00	Lobby A GH Column 14 BeMatrix Box-4 Sided	Lobby A	38.875 W x 94.9375 H
39	1	1	\$6,500.00	Lobby A Wall Banner Above Columns-Left	Lobby A	15' W x 9' H
40	1	1	\$6,500.00	Lobby A Wall Banner Above Columns-Center	Lobby A	15' W x 9' H

41	1	1	\$6,500.00	Lobby A Wall Banner Above Columns-Right	Lobby A	15' W x 9' H
42	1	1	\$7,500.00	Lobby A Wall Banner Across from Reg Area-Left (20 x 12)	Lobby A	20' W x 12' H
43	1	0	\$7,500.00	Lobby A Wall Banner Across from Reg Area-Center (20 x 12)	Lobby A	20' W x 12' H
44	1	1	\$7,500.00	Lobby A Wall Banner Across from Reg Area-Right (20 x 12)	Lobby A	20' W x 12' H
45	1	0	\$7,500.00	Lobby A SEG Wall Panel 1A Across from Reg Area	Lobby A	116.625" W x 94.9375" H
46	1	0	\$7,500.00	Lobby A SEG Wall Panel 2A Across from Reg Area	Lobby A	116.625" W x 94.9375" H
47	1	0	\$2,500.00	Lobby A Floor Cling	Lobby A	11' W x 4' H
48	1	0	\$1,500.00	Lobby A Escalator Runner-Left	Lobby A	8" W x 70' 11" H
49	1	0	\$1,500.00	Lobby A Escalator Runner-Right	Lobby A	8" W x 70' 11" H
50	1	1	\$7,500.00	Lobby A Wall Banner Above Charging Station Faubourg-Marigny	Lobby A	14' W x 14' H
51	1	1	\$10,000.00	Wall Banner Over the Doors to Magnolia Porch	Lobby A	58' W x 5' 5" H
				Lobby B 1 & 2		
52	1	0	\$4,000.00	Lobby B1 Entrance Wall Banner A (Hallway to Doors)	Lobby B1	22' W x 57" H
53	1	0	\$2,500.00	Lobby B1 Entrance Wall Banner B (Above the Doors)	Lobby B1	22' W x 2' H
54	1	0	\$5,000.00	Lobby B1 SEG Wall Panel 1B	Lobby B1	116.625" W x 94.9375" H
55	1	0	\$5,000.00	Lobby B1 SEG Wall Panel 2B	Lobby B1	116.625" W x 94.9375" H
56	1	1	\$7,500.00	Lobby B1 Hanging Banner C (25' W x 12' H)	Lobby B1	25' W x 13' H
57	1	1	\$7,500.00	Lobby B1 Hanging Banner D (20' W x 12' H)	Lobby B1	25' W x 13' H
58	1	1	\$7,500.00	Lobby B1 Hanging Banner E (20' W x 12' H)	Lobby B1	25' W x 13' H
59	1	1	\$10,000.00	Lobby B1 Wall Cling F (20' W x 24' H)	Lobby B1	20' W x 24' H
60	1	1	\$10,000.00	Lobby B1 Wall Cling G (29' W x 16' H)	Lobby B1	29' W x 16' H
61	1	1	\$1,500.00	Lobby B1 Escalator Runner-Left	Lobby B1	8" W x 70' 4" H
62	1	1	\$1,500.00	Lobby B1 Escalator Runner-Right	Lobby B1	8" W x 70' 4" H
63	1	1	\$2,500.00	Lobby B1 Floor Cling	Lobby B1	11' W x 4' H
64	1	1	\$1,500.00	Lobby B1 Men's & Women's Restroom Mirror Clings	Lobby B1	8" W x 8" H



SIOP ANNUAL CONFERENCE

NEW ORLEANS • April 29–May 2, 2026

THE BOULEVARD MINI LOUNGE C

OPPORTUNITY

#8

Exhibit Hall

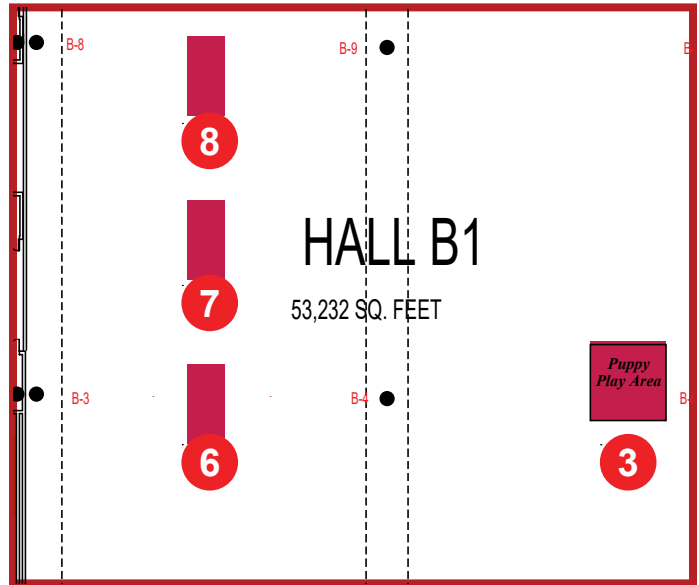

PRINTING & INSTALLATION FEE

\$7,500

LOUNGE AREA

10' x 20'

ADDITIONAL INFO

One of three seating areas on the main aisle between the entrance doors and the poster sessions.



SIOP ANNUAL CONFERENCE

NEW ORLEANS • April 29–May 2, 2026

BRAIN BREAK BOOTH

Exhibit Hall

OPPORTUNITY

#9

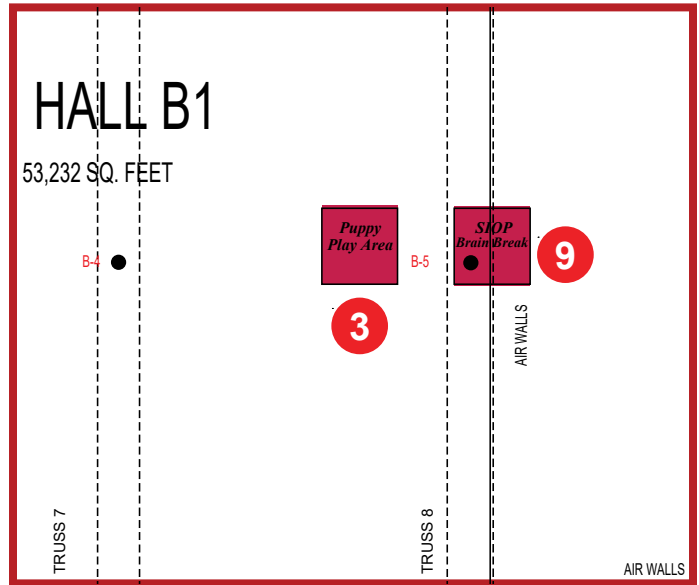

PRINTING & INSTALLATION FEE

\$6,000

BOOTH AREA

20' x 20'

ADDITIONAL INFO

A 20' x 20' booth intended to provide a pause in a busy day. This booth will include jigsaw puzzles, legos, and other relaxing games. Build your 10 x 10 booth as part of this experience.



SIOP ANNUAL CONFERENCE

NEW ORLEANS • April 29-May 2, 2026

DOUBLE SIDED METER BOARD A

OPPORTUNITY

#13

Great Hall Lobby

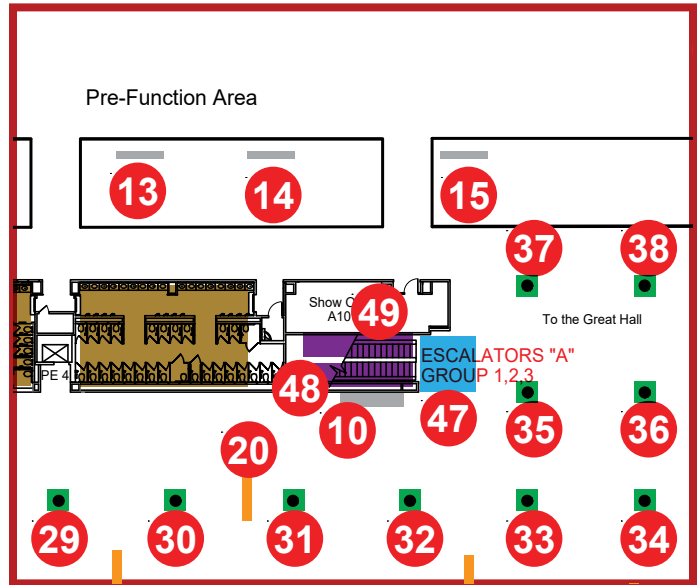

PRINTING & INSTALLATION FEE

\$1,250

METER BOARD A

38" x 96"

ADDITIONAL INFO

This is a two-sided meter board. Size is 38" wide x 96" high. Located outside of Opening Plenary and near an entrance to the exhibit hall.



SIOP ANNUAL CONFERENCE

NEW ORLEANS • April 29-May 2, 2026

CEILING BANNER

Lobby A

OPPORTUNITY

#21

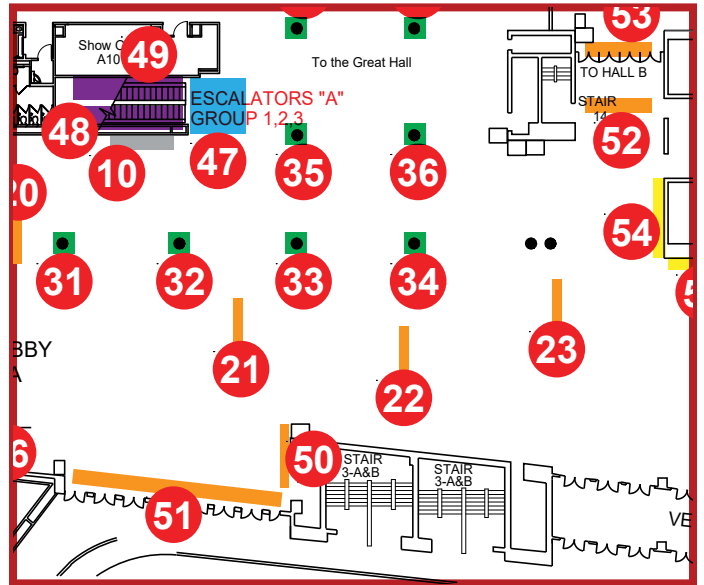

PRINTING & INSTALLATION FEE

\$3,750

BANNER PH1-WS2

10' x 8'

ADDITIONAL INFO

Double sided Banner



SIOP ANNUAL CONFERENCE

NEW ORLEANS • April 29-May 2, 2026

CEILING BANNER

Lobby B1

OPPORTUNITY

#25

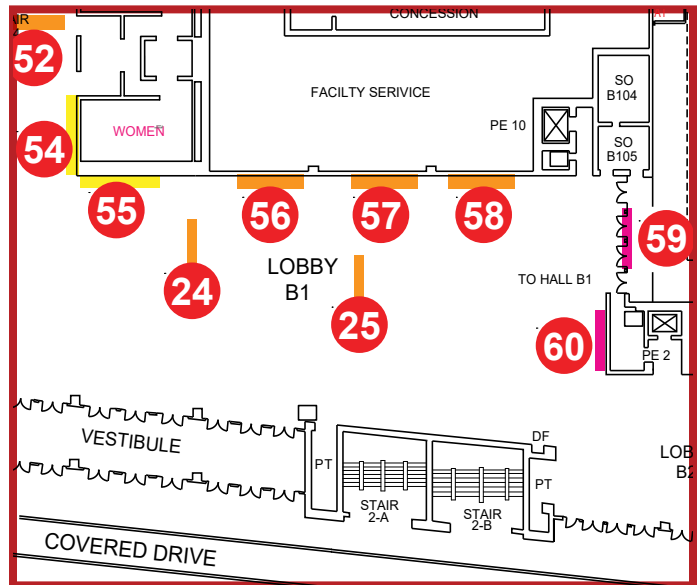

PRINTING & INSTALLATION FEE

\$3,750

BANNER PH1-WS4

10' x 8'

ADDITIONAL INFO

Double-sided hanging banner



SIOP ANNUAL CONFERENCE

NEW ORLEANS • April 29–May 2, 2026

BEMATRIX COLUMN WRAP 2

OPPORTUNITY

#26

Lobby A

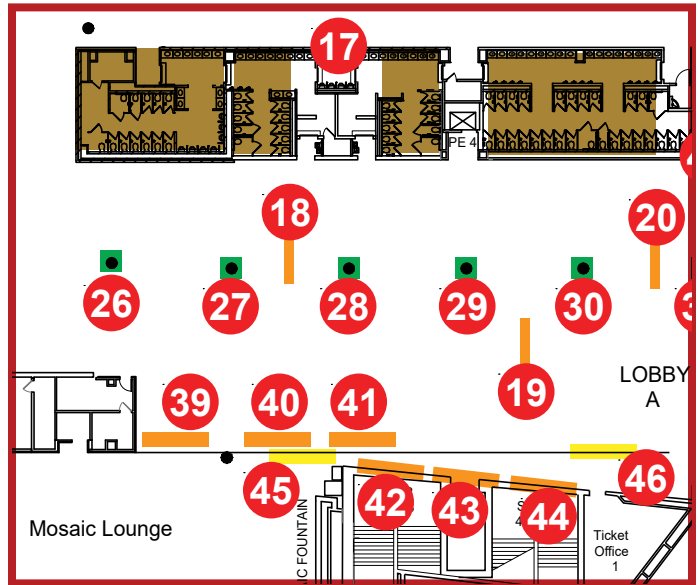

PRINTING & INSTALLATION FEE

\$5,000

COLUMN WRAP

38.875" x 94.9375" (x4)

ADDITIONAL INFO

Can be same design or up to 4 different designs.



SIOP ANNUAL CONFERENCE

NEW ORLEANS • April 29–May 2, 2026

BEMATRIX COLUMN WRAP 3

OPPORTUNITY

#27

Lobby A

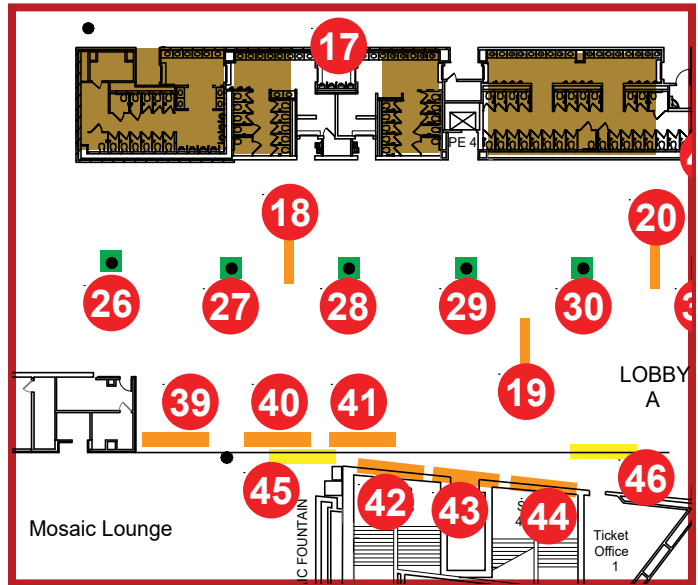
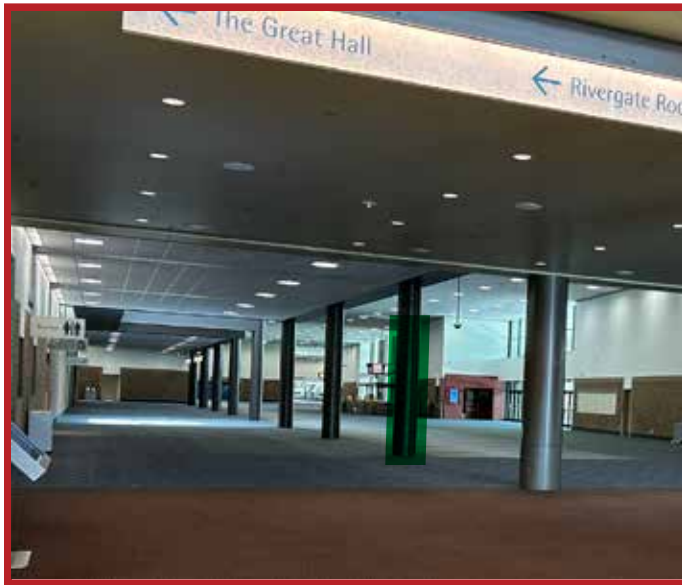

PRINTING & INSTALLATION FEE

\$5,000

COLUMN WRAP

38.875" x 94.9375" (x4)

ADDITIONAL INFO

Can be same design or up to 4 different designs.



SIOP ANNUAL CONFERENCE

NEW ORLEANS • April 29–May 2, 2026

BEMATRIX COLUMN WRAP 4

OPPORTUNITY

#28

Lobby A

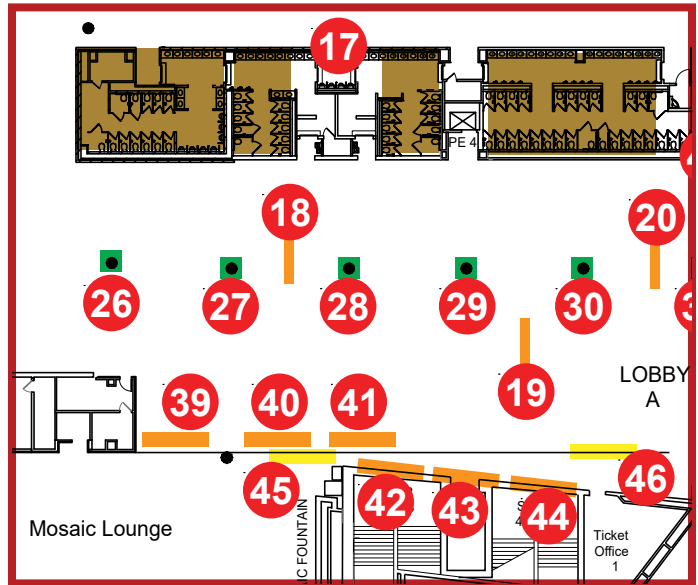
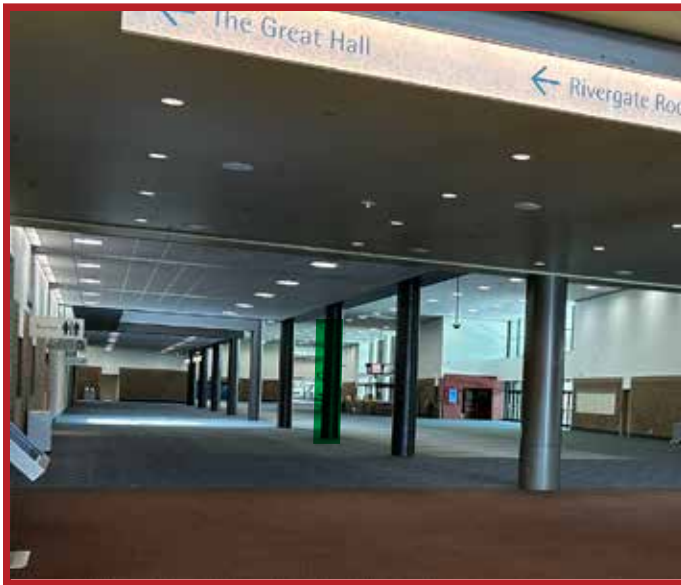

PRINTING & INSTALLATION FEE

\$5,000

COLUMN WRAP

38.875" x 94.9375" (x4)

ADDITIONAL INFO

Can be same design or up to 4 different designs.



SIOP ANNUAL CONFERENCE

NEW ORLEANS • April 29–May 2, 2026

BEMATRIX COLUMN WRAP 5

OPPORTUNITY

#29

Lobby A

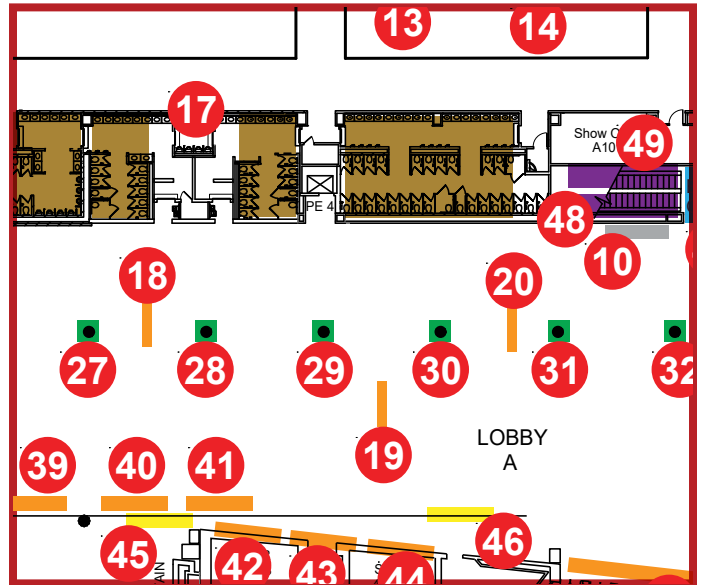

PRINTING & INSTALLATION FEE

\$5,000

COLUMN WRAP

38.875" x 94.9375" (x4)

ADDITIONAL INFO

Can be same design or up to 4 different designs.



SIOP ANNUAL CONFERENCE

NEW ORLEANS • April 29-May 2, 2026

BEMATRIX COLUMN WRAP 6

OPPORTUNITY

#30

Lobby A

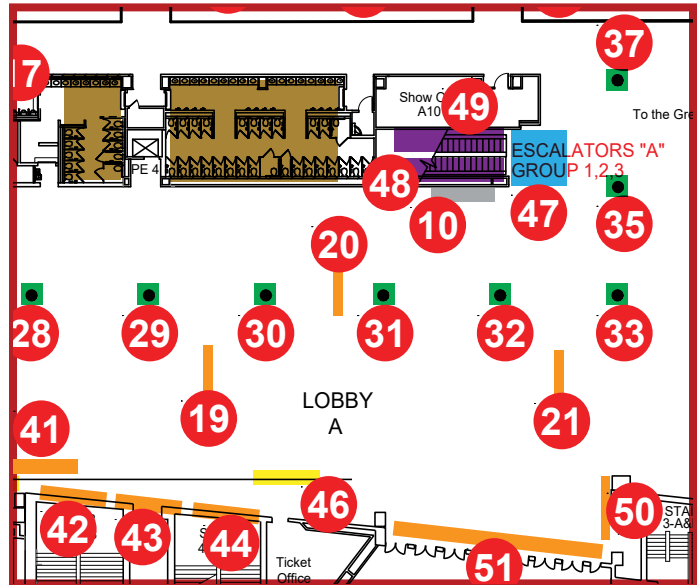

PRINTING & INSTALLATION FEE

\$5,000

COLUMN WRAP

38.875" x 94.9375" (x4)

ADDITIONAL INFO

Can be same design or up to 4 different designs.



SIOP ANNUAL CONFERENCE

NEW ORLEANS • April 29–May 2, 2026

BEMATRIX COLUMN WRAP 7

OPPORTUNITY

#31

Lobby A

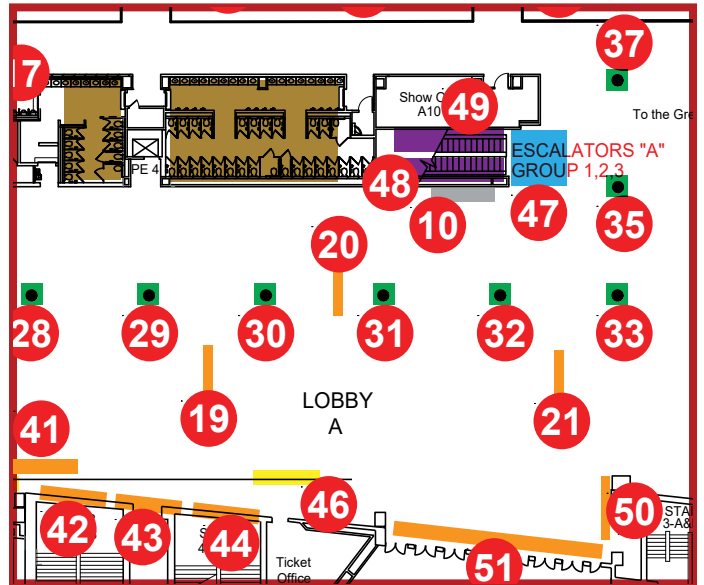

PRINTING & INSTALLATION FEE

\$5,000

COLUMN WRAP

38.875" x 94.9375" (x4)

ADDITIONAL INFO

Can be same design or up to 4 different designs.



SIOP ANNUAL CONFERENCE

NEW ORLEANS • April 29–May 2, 2026

BEMATRIX COLUMN WRAP 8

OPPORTUNITY

#32

Lobby A

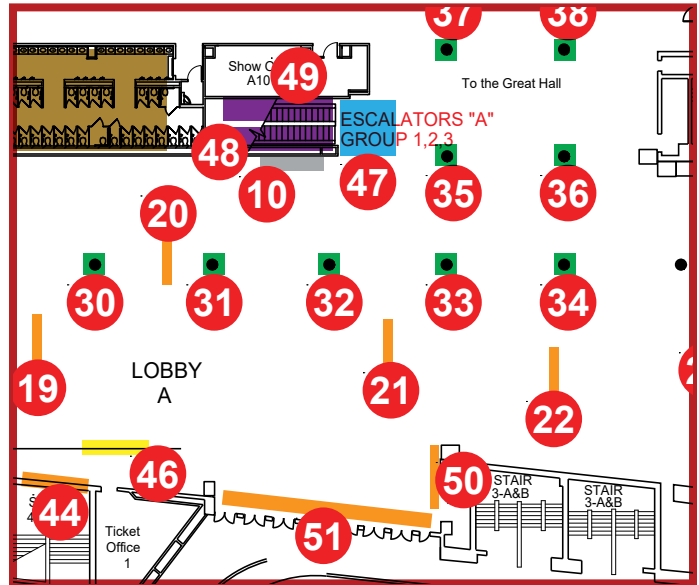

PRINTING & INSTALLATION FEE

\$5,000

COLUMN WRAP

38.875" x 94.9375" (x4)

ADDITIONAL INFO

Can be same design or up to 4 different designs.



SIOP ANNUAL CONFERENCE

NEW ORLEANS • April 29–May 2, 2026

BEMATRIX COLUMN WRAP 9

OPPORTUNITY

#33

Lobby A

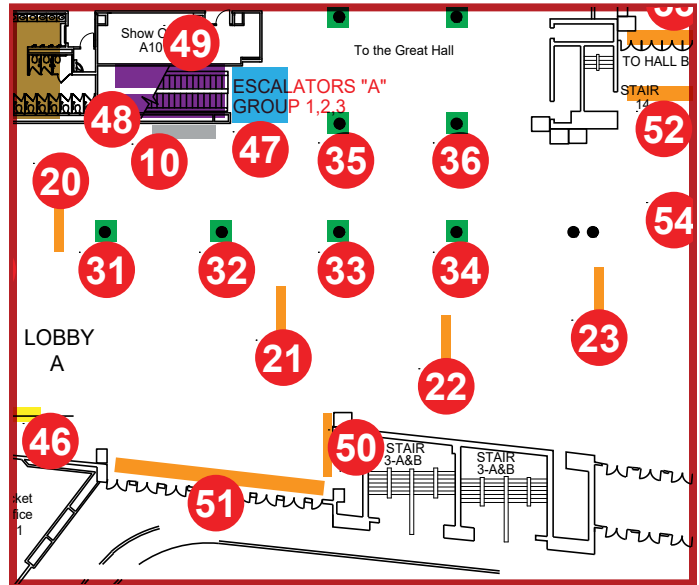

PRINTING & INSTALLATION FEE

\$5,000

COLUMN WRAP

38.875" x 94.9375" (x4)

ADDITIONAL INFO

Can be same design or up to 4 different designs.



SIOP ANNUAL CONFERENCE

NEW ORLEANS • April 29–May 2, 2026

BEMATRIX COLUMN WRAP 10

OPPORTUNITY

#34

Lobby A

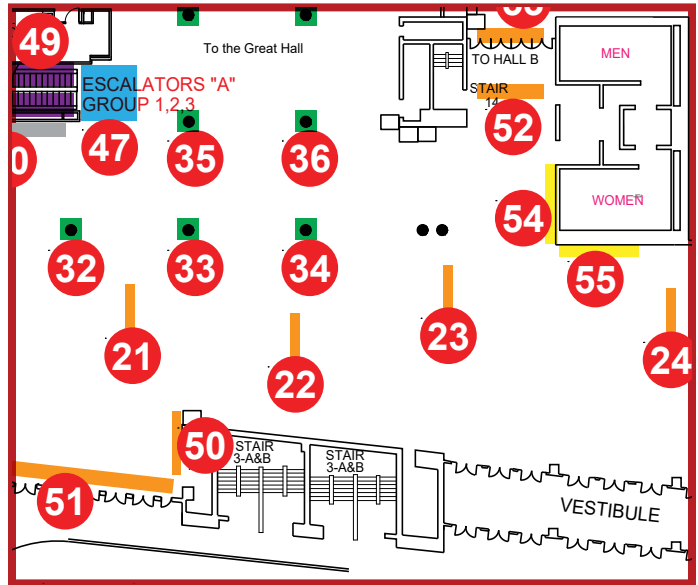

PRINTING & INSTALLATION FEE

\$5,000

COLUMN WRAP

38.875" x 94.9375" (x4)

ADDITIONAL INFO

Can be same design or up to 4 different designs.



SIOP ANNUAL CONFERENCE

NEW ORLEANS • April 29-May 2, 2026

BEMATRIX COLUMN WRAP 11

OPPORTUNITY

#35

Lobby A



PRINTING & INSTALLATION FEE

\$5,000

COLUMN WRAP

38.875" x 94.9375" (x4)

ADDITIONAL INFO

Can be same design or up to 4 different designs.



SIOP ANNUAL CONFERENCE

NEW ORLEANS • April 29-May 2, 2026

BEMATRIX COLUMN WRAP 12

OPPORTUNITY

#36

Lobby A

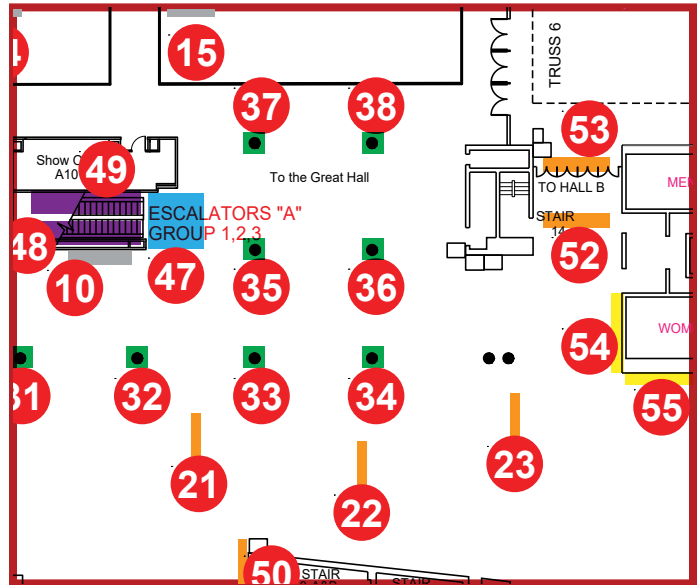

PRINTING & INSTALLATION FEE

\$5,000

COLUMN WRAP

38.875" x 94.9375" (x4)

ADDITIONAL INFO

Can be same design or up to 4 different designs.



SIOP ANNUAL CONFERENCE

NEW ORLEANS • April 29–May 2, 2026

WALL BANNER ABOVE COLUMN (LEFT)

OPPORTUNITY

#39

Lobby A

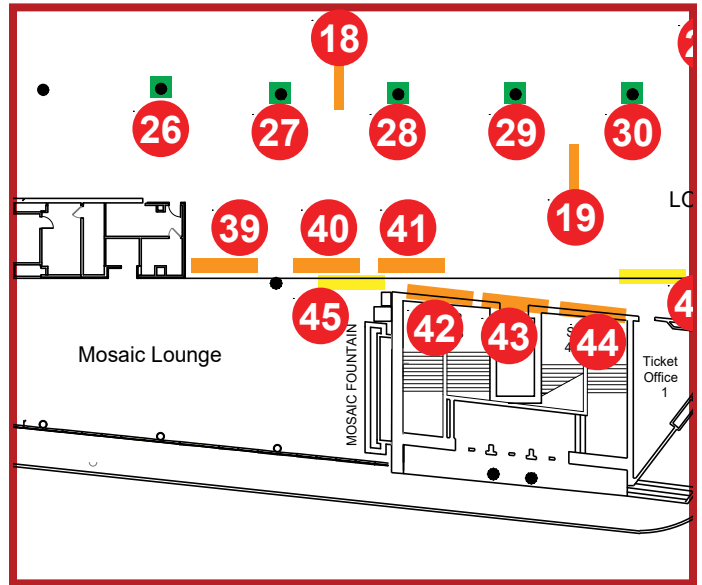

PRINTING & INSTALLATION FEE

\$6,500

BANNER-LEFT

15'x9'

ADDITIONAL INFO

Single-sided vinyl wall cling. Near entrance and above Lobby A. Highly visible to all attendees.



SIOP ANNUAL CONFERENCE

NEW ORLEANS • April 29–May 2, 2026

WALL BANNER ABOVE COLUMN (RIGHT)

OPPORTUNITY

#41

Lobby A

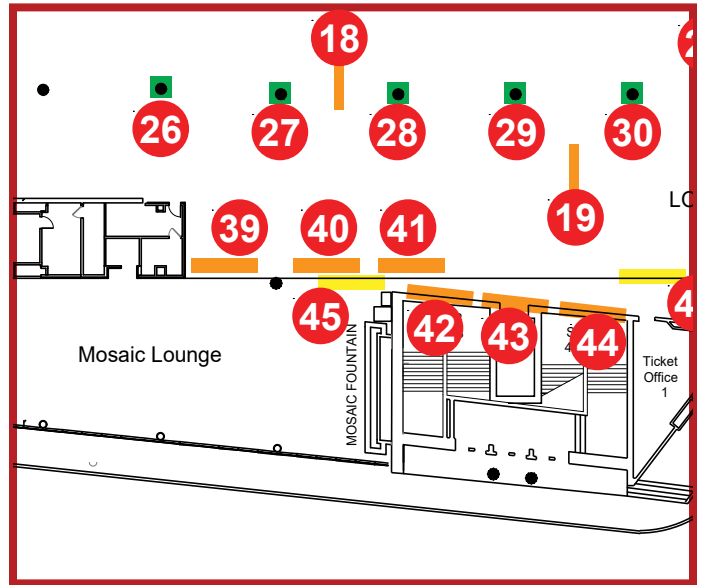

PRINTING & INSTALLATION FEE

\$6,500

BANNER-RIGHT

15'x9'

ADDITIONAL INFO

Single-sided vinyl wall cling. Next to but above Registration Area. Highly visible to all attendees.



SIOP ANNUAL CONFERENCE

NEW ORLEANS • April 29-May 2, 2026

WALL BANNER ACROSS FROM REGISTRATION OPPORTUNITY

#42

Lobby A

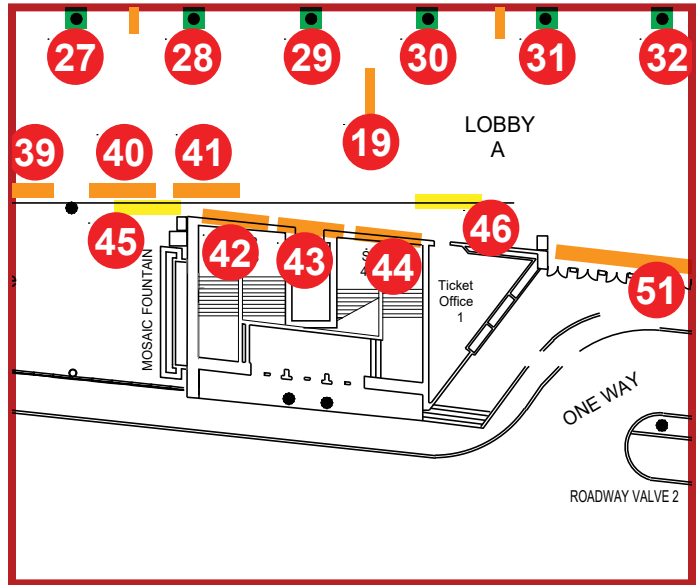
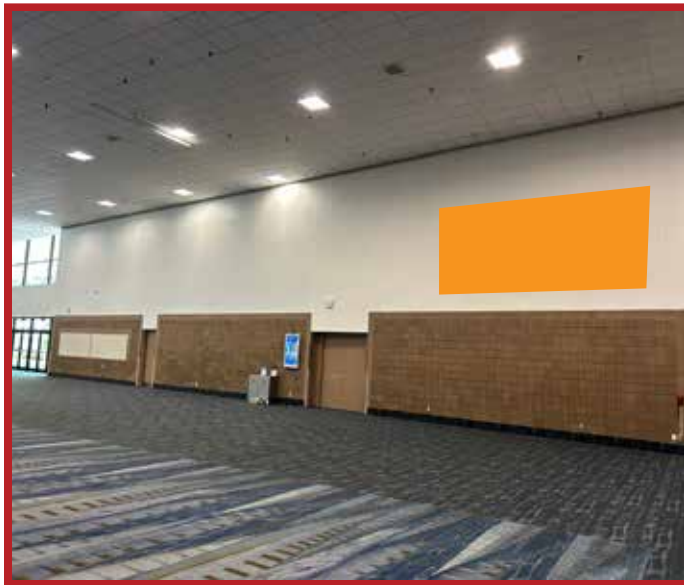

PRINTING & INSTALLATION FEE

\$7,500

BANNER-RIGHT

20' x 12'

ADDITIONAL INFO

Single-sided vinyl wall cling. Highly visible to all attendees.



SIOP ANNUAL CONFERENCE

NEW ORLEANS • April 29-May 2, 2026

WALL BANNER ACROSS FROM REGISTRATION OPPORTUNITY

#44

Lobby A

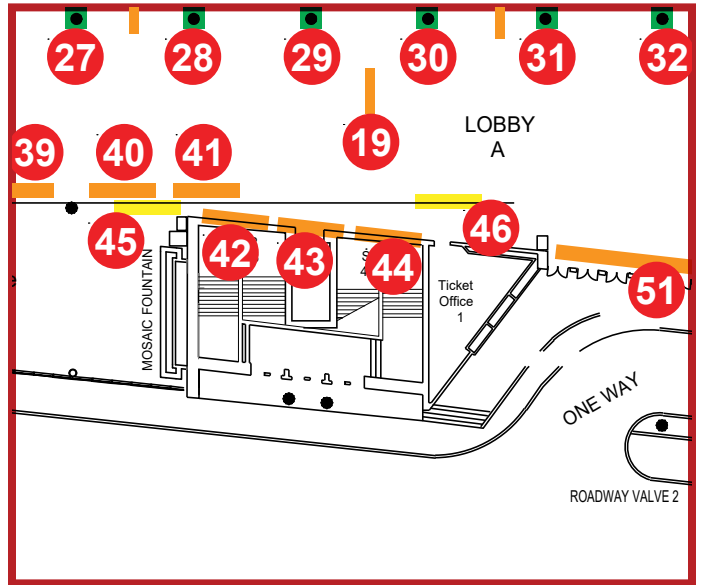
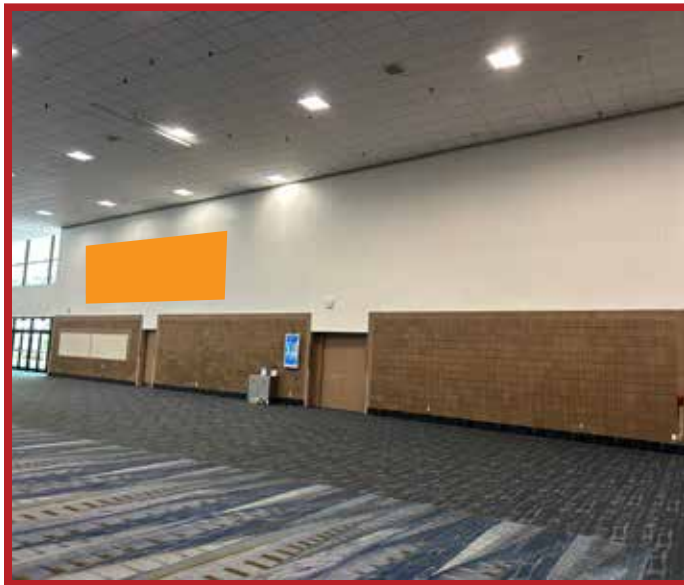

PRINTING & INSTALLATION FEE

\$7,500

BANNER-LEFT

20' x 12'

ADDITIONAL INFO

Single-sided vinyl wall cling. Highly visible to all attendees.



SIOP ANNUAL CONFERENCE

NEW ORLEANS • April 29–May 2, 2026

WALL BANNER ABOVE CHARGING

OPPORTUNITY

#50

Lobby A

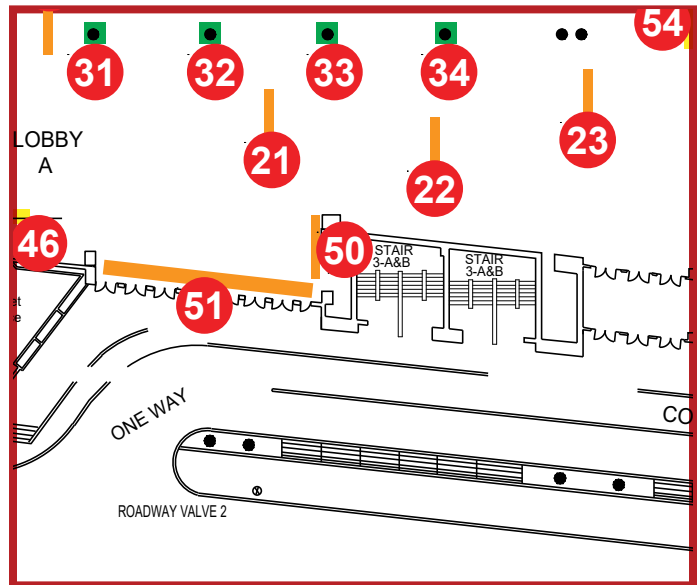

PRINTING & INSTALLATION FEE

\$7,500

BANNER

14' x 14'

ADDITIONAL INFO

Single-sided vinyl wall cling above the charging station called Faubourg-Marigny.



SIOP ANNUAL CONFERENCE

NEW ORLEANS • April 29–May 2, 2026

WALL BANNER OVER THE DOORS TO MAGNOLIA PORCH

OPPORTUNITY

#51

Lobby A

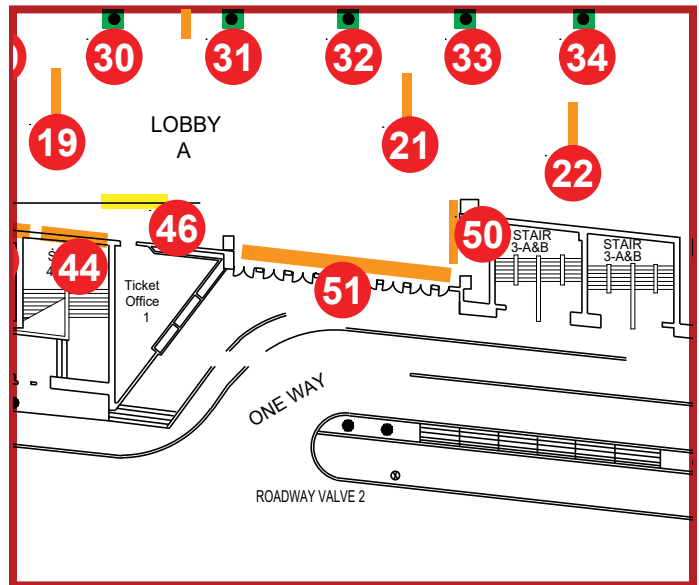

PRINTING & INSTALLATION FEE

\$10,000

BANNER

58' x 5' 5"

ADDITIONAL INFO

Single-sided vinyl wall cling.



SIOP ANNUAL CONFERENCE

NEW ORLEANS • April 29–May 2, 2026

HANGING BANNER 1

Lobby B

OPPORTUNITY

#56

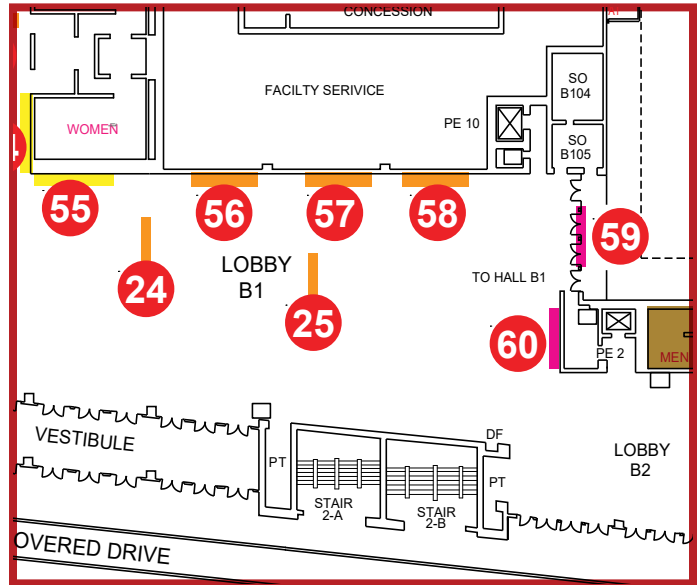

PRINTING & INSTALLATION FEE

\$7,500

BANNER

25' x 12'

ADDITIONAL INFO

Single-sided vinyl hanging wall banner.

Banner is visible from both Lobby A and Lobby B1. Activities will be taking place in the rooms behind this wall in Meeting Rooms B2-1 and B2-2.



SIOP ANNUAL CONFERENCE

NEW ORLEANS • April 29-May 2, 2026

HANGING BANNER 2

OPPORTUNITY

#57

Lobby B

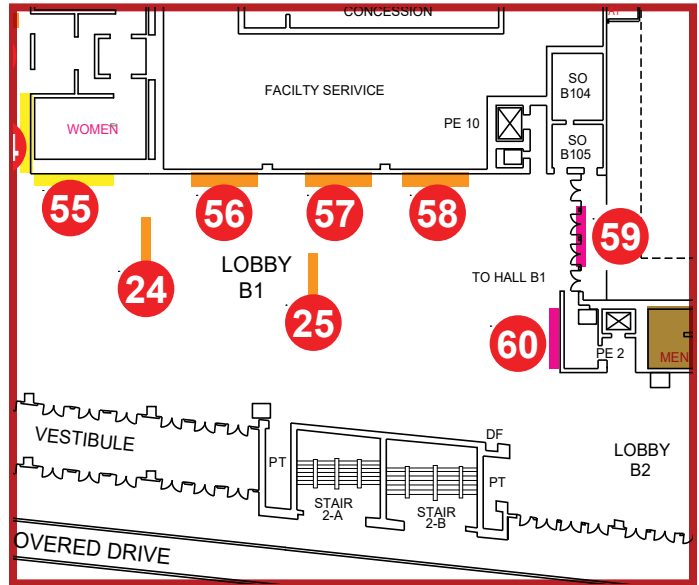

PRINTING & INSTALLATION FEE

\$7,500

BANNER

25' x 12'

ADDITIONAL INFO

Single-sided vinyl hanging wall banner.

Banner is visible from both Lobby A and Lobby B1. Activities will be taking place in the rooms behind this wall in Meeting Rooms B2-1 and B2-2.



SIOP ANNUAL CONFERENCE

NEW ORLEANS • April 29–May 2, 2026

HANGING BANNER 3

Lobby B

OPPORTUNITY

#58

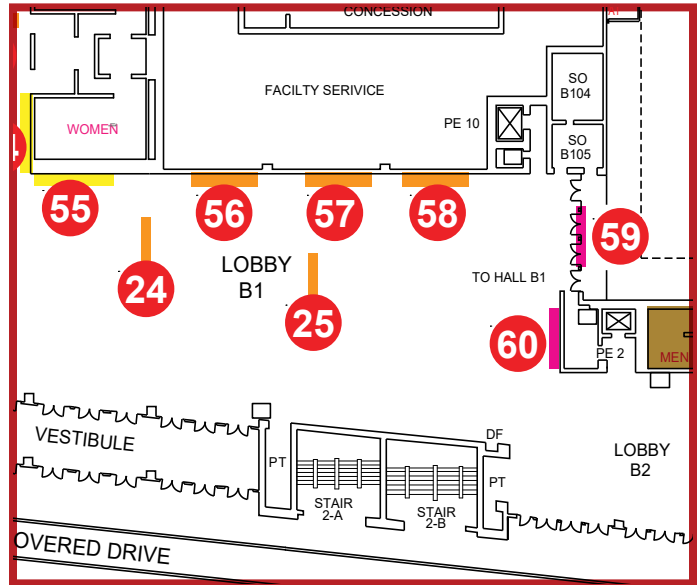

PRINTING & INSTALLATION FEE

\$7,500

BANNER

25' x 12'

ADDITIONAL INFO

Single-sided vinyl hanging wall banner.

Banner is visible from both Lobby A and Lobby B1. Activities will be taking place in the rooms behind this wall in Meeting Rooms B2-1 and B2-2.



SIOP ANNUAL CONFERENCE

NEW ORLEANS • April 29-May 2, 2026

WALL CLING

Lobby B

OPPORTUNITY

#59

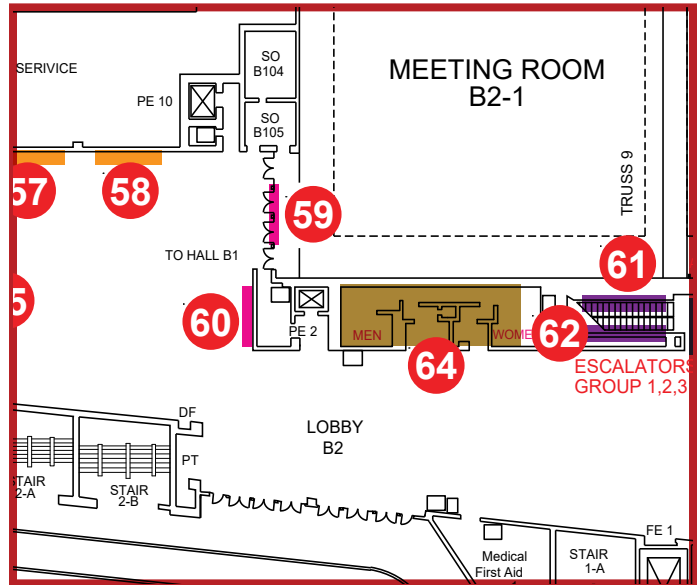
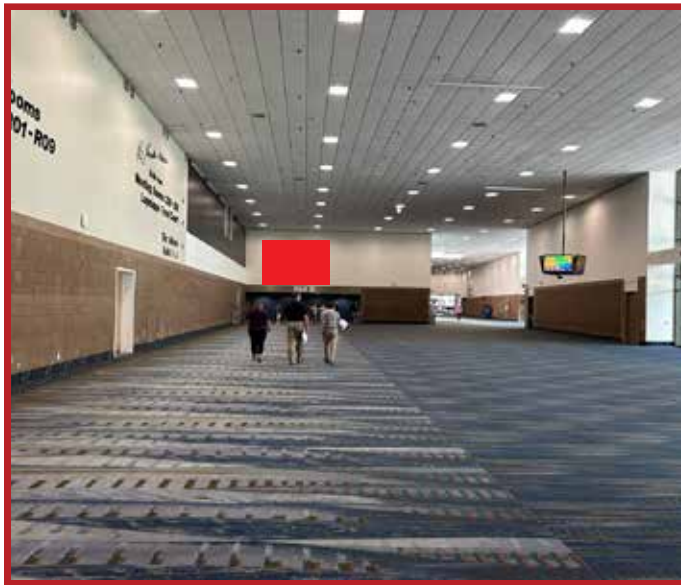

PRINTING & INSTALLATION FEE

\$10,000

WALL CLING

20' x 24'

ADDITIONAL INFO

Banner is visible from both Lobby A and Lobby B1. Activities will be taking place in the rooms behind this wall in Meeting Rooms B2-1 and B2-2.



SIOP ANNUAL CONFERENCE

NEW ORLEANS • April 29-May 2, 2026

WALL CLING

Lobby B

OPPORTUNITY

#60

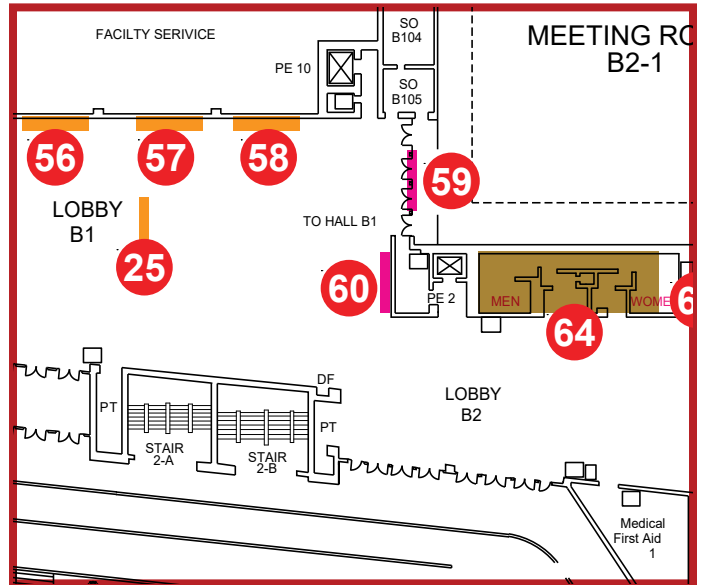

PRINTING & INSTALLATION FEE

\$10,000

WALL CLING

29' x 16'

ADDITIONAL INFO

Banner is visible from both Lobby A and Lobby B1. Activities will be taking place in the rooms behind this wall in Meeting Rooms B2-1 and B2-2.



SIOP ANNUAL CONFERENCE

NEW ORLEANS • April 29–May 2, 2026

ESCALATOR RUNNER LEFT

OPPORTUNITY

#61

Lobby B

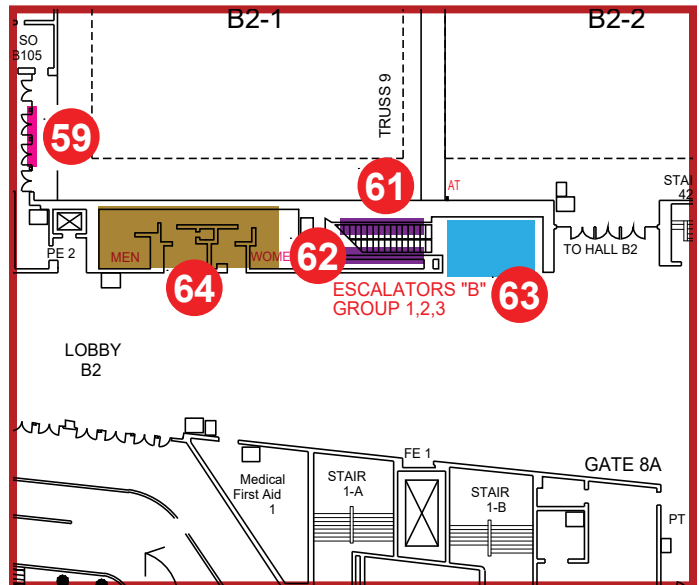

PRINTING & INSTALLATION FEE

\$1,500

ESCALATOR CLING

8" x 70' 4"

ADDITIONAL INFO

Vinyl Cling in between the handrails on the escalator to second floor, where the educational sessions will be held.



SIOP ANNUAL CONFERENCE

NEW ORLEANS • April 29–May 2, 2026

ESCALATOR RUNNER RIGHT

OPPORTUNITY

#62

Lobby B

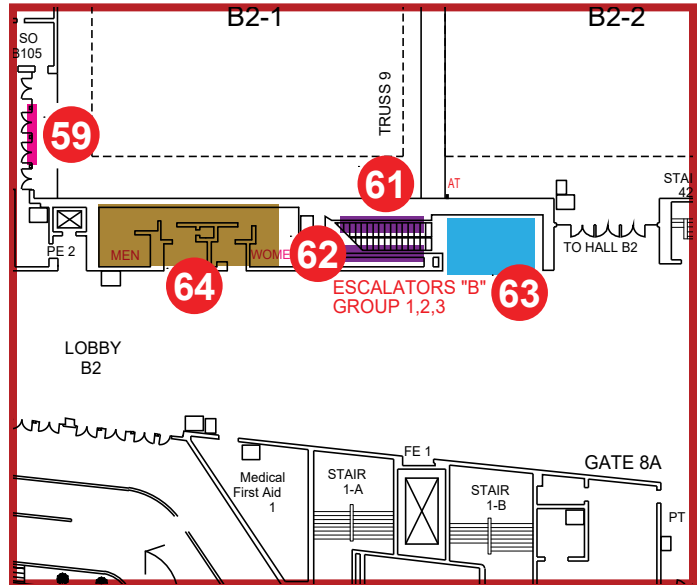

PRINTING & INSTALLATION FEE

\$1,500

ESCALATOR CLING

8" x 70' 4"

ADDITIONAL INFO

Vinyl Cling in between the handrails on the escalator to second floor, where the educational sessions will be held.



SIOP ANNUAL CONFERENCE

NEW ORLEANS • April 29–May 2, 2026

ESCALATOR FLOOR CLING

OPPORTUNITY

#63

Lobby B

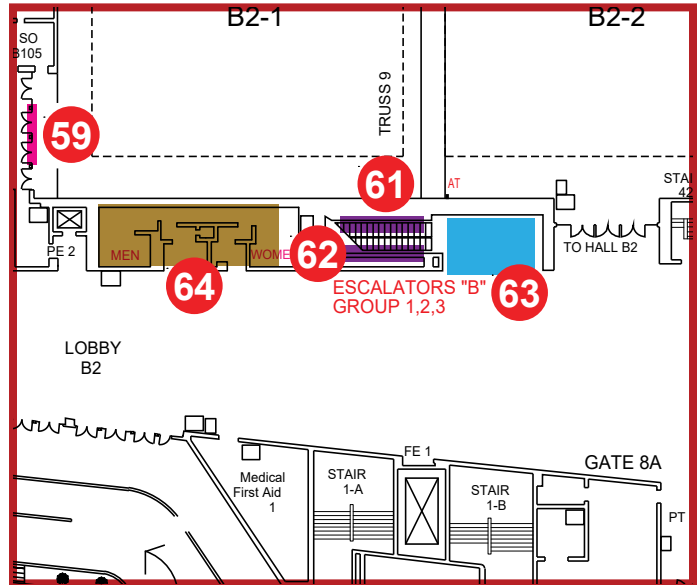

PRINTING & INSTALLATION FEE

\$2,500

FLOOR CLING

11' W x 4' H

ADDITIONAL INFO

Vinyl Cling on floor in front of escalators to second floor, where the educational sessions will be held.



SIOP ANNUAL CONFERENCE

NEW ORLEANS • April 29–May 2, 2026

RESTROOM MIRROR CLINGS

OPPORTUNITY

#64

Lobby B

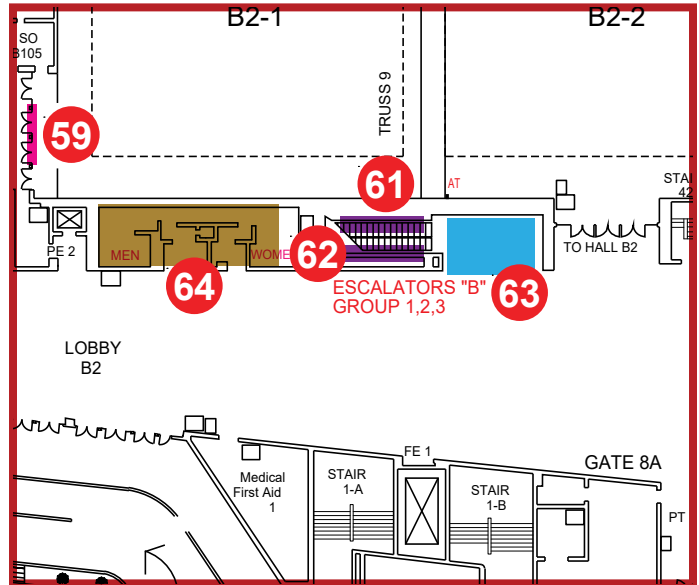

PRINTING & INSTALLATION FEE

\$1,500

MIRROR CLINGS

8" x 8"

ADDITIONAL INFO

Lobby B Men's & Women's Restroom mirrors. Same design on all clings.